

ADVANCED
HOUSE PLANS

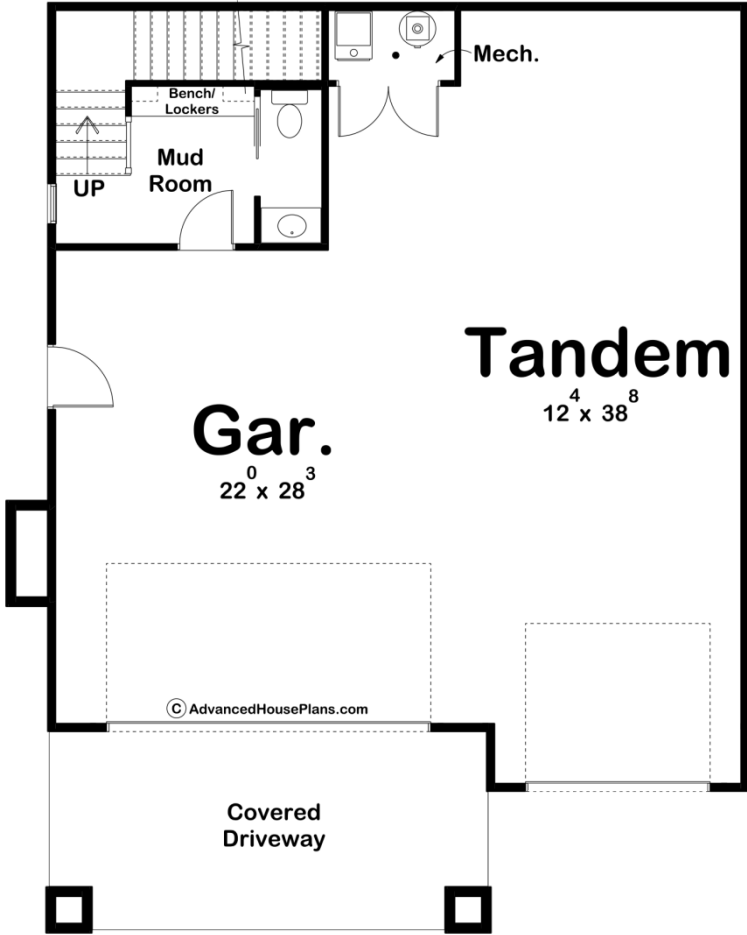

30204 - Meadow Lane Data Sheet

1453 SQ FT	2 BEDS	2 BATHS	3 BAYS	37' 0" WIDE	46' 4" DEEP
---------------	-----------	------------	-----------	----------------	----------------



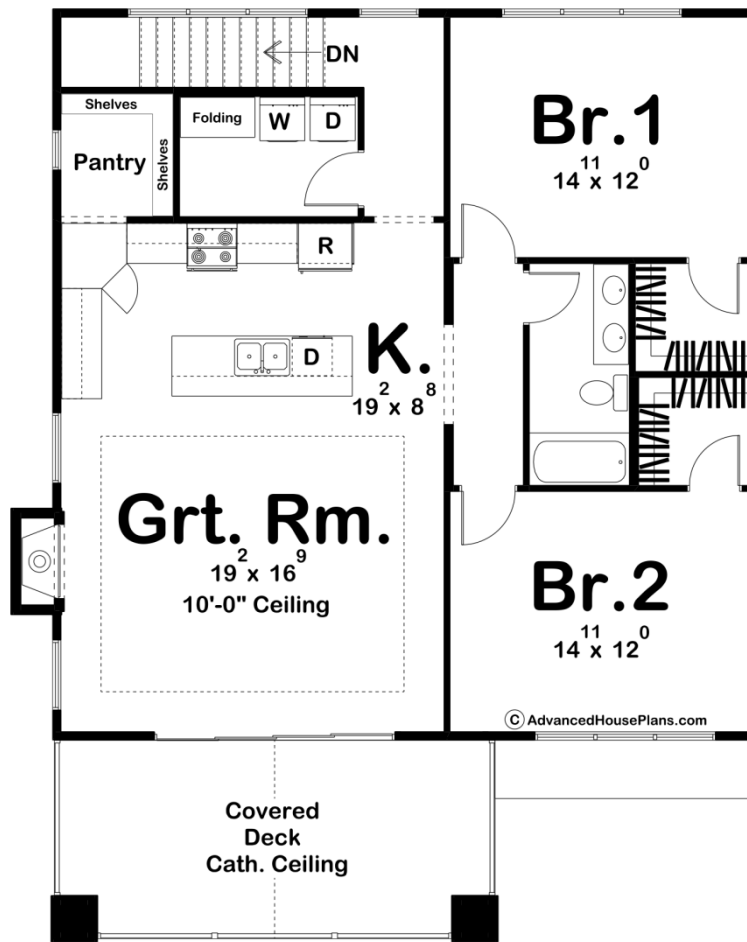

Construction Specs

Layout

Bedrooms	2
Bathrooms	2
Garage Bays	3

Square Footage

Main Level	169 Sq. Ft.
Second Level	1284 Sq. Ft.
Covered Area	219 Sq. Ft.
Garage	1142 Sq. Ft.
Total Finished Area	1453 Sq. Ft.

Exterior Dimensions

Width	37' 0"
Depth	46' 4"
Ridge Height	33' 2"
<i>Calculated from main floor line</i>	

Default Construction Stats

Stats are unique to the individual plan.

Foundation Type	Slab
Exterior Wall Construction	2x4
Roof Pitches	Primary 10/12, Secondary 8/12, 4/12
Main Wall Height	10'
Second Wall Height	9'

Plan Description

The Meadow Lane is a stunning apartment garage that features 2 bedrooms above a 3 car garage. On the main level there is a mudroom equipped with bench & lockers and a half bath. There is extra storage space in the rear of the single car stall. Upstairs, a well-thought out apartment includes 2 bedrooms with walk-in closets and a shared hall bath. The open concept flows from the full kitchen with a walk-in pantry to the large great room that houses a fireplace and tray ceiling. Off the great room is a large slider door that opens to a covered deck with cathedral ceiling.