

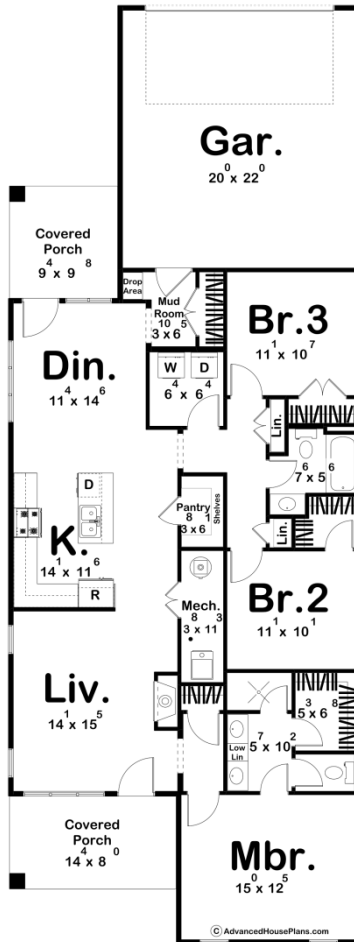

30558 - Millwood Data Sheet

1483 SQ FT	3 BEDS	2 BATHS	2 BAYS	30' 0" WIDE	80' 0" DEEP
---------------	-----------	------------	-----------	----------------	----------------



Construction Specs

Layout

Bedrooms

Bathrooms	2
Garage Bays	2
Square Footage	
Main Level	1483 Sq. Ft.
Covered Area	205 Sq. Ft.
Garage	462 Sq. Ft.
Total Finished Area	1483 Sq. Ft.
Exterior Dimensions	
Width	30' 0"
Depth	80' 0"
Ridge Height <i>Calculated from main floor line</i>	24' 7"
Default Construction Stats <i>Stats are unique to the individual plan.</i>	
Foundation Type	Slab
Exterior Wall Construction	2x4
Roof Pitches	Primary 8/12, Secondary 4/12, 10/12
Main Wall Height	9'

Plan Description

Welcome to this charming modern farmhouse, where classic style meets contemporary comfort in a beautifully compact design. The exterior features both a front and rear covered porch ideal for providing welcoming outdoor spaces for relaxation and entertainment. Step inside and be greeted by a thoughtfully laid-out interior that maximizes space and functionality. The entry opens directly into the cozy, open-concept living area, where natural light pours in through large windows which highlight the modern finishes. At the rear, you'll find the garage tucked away, seamlessly integrating with the home's design while maintaining an uncluttered front view. The rear covered porch extends the living space outdoors, ideal for enjoying serene evenings or lively barbecues. This narrow, yet expansive, modern farmhouse is the perfect blend of functional design and timeless charm, offering a stylish and efficient living experience.