

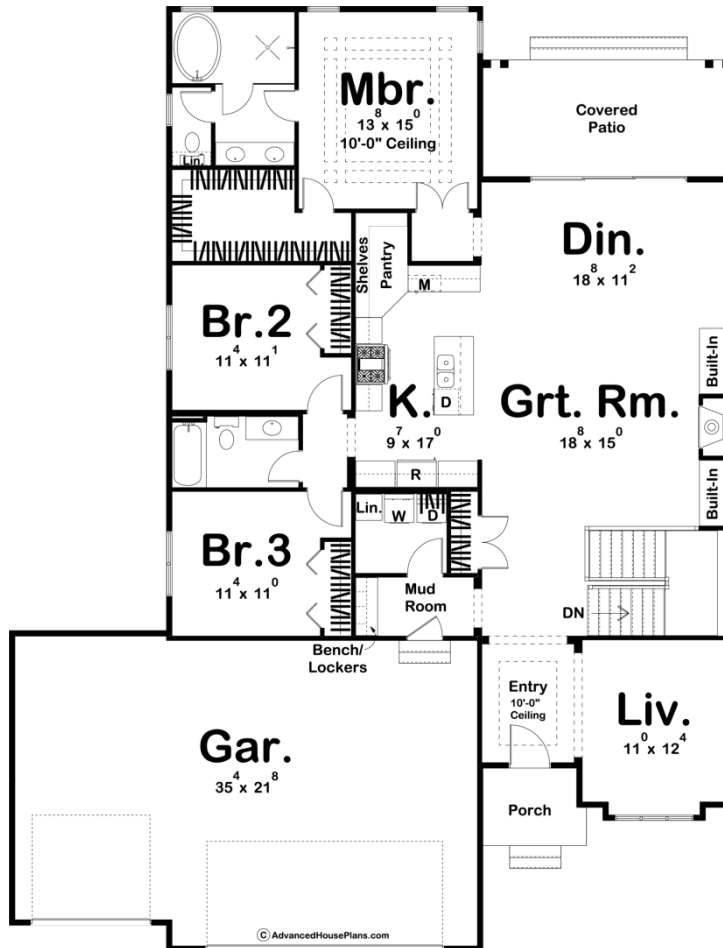

**29938 - Naperville Data Sheet**

|               |           |            |           |                |                |
|---------------|-----------|------------|-----------|----------------|----------------|
| 2061<br>SQ FT | 3<br>BEDS | 2<br>BATHS | 3<br>BAYS | 55' 0"<br>WIDE | 72' 0"<br>DEEP |
|---------------|-----------|------------|-----------|----------------|----------------|



**Construction Specs**

Layout

Bedrooms

|             |   |
|-------------|---|
| Bathrooms   | 2 |
| Garage Bays | 3 |

### Square Footage

|                     |              |
|---------------------|--------------|
| Main Level          | 2061 Sq. Ft. |
| Covered Area        | 171 Sq. Ft.  |
| Garage              | 833 Sq. Ft.  |
| Total Finished Area | 2061 Sq. Ft. |

### Exterior Dimensions

|       |        |
|-------|--------|
| Width | 55' 0" |
| Depth | 72' 0" |

### Default Construction Stats

*Stats are unique to the individual plan.*

|                            |               |
|----------------------------|---------------|
| Foundation Type            | Basement      |
| Exterior Wall Construction | 2x4           |
| Roof Pitches               | 10/12 Primary |
| Foundation Wall Height     | 9'            |
| Main Wall Height           | 9'            |

## Plan Description

Featuring a beautiful modern farmhouse exterior facade, the Naperville is a charming 1 story house plan with a great floor plan to match! The front of the house shows fantastic curb appeal with its porch and contrasting siding materials and colors. The Naperville features an open floor plan that feels huge! It's got a deep walk-in pantry, hidden by cabinet-faced doors and bench and locker storage in the mudroom to keep your belongings organized. The great room is warmed by a fireplace that is flanked by built-in bookshelves. At the rear of the home, the master suite is generously sized with a shower and spa room and a spacious walk-in closet. Located on the left side of the home, bedrooms 2 and 3 share a centrally located hall bathroom.