

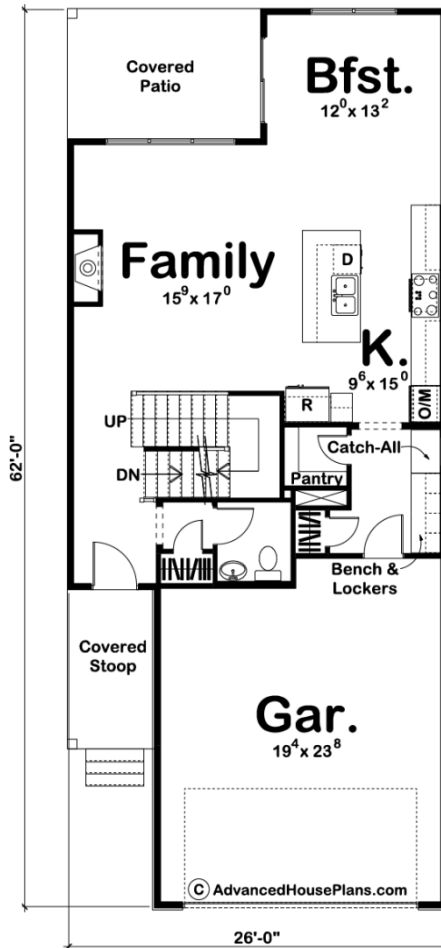

**29311 - Newberry Data Sheet**

1952 SQ FT	3 BEDS	3 BATHS	2 BAYS	26' 0" WIDE	62' 0" DEEP
---------------	-----------	------------	-----------	----------------	----------------

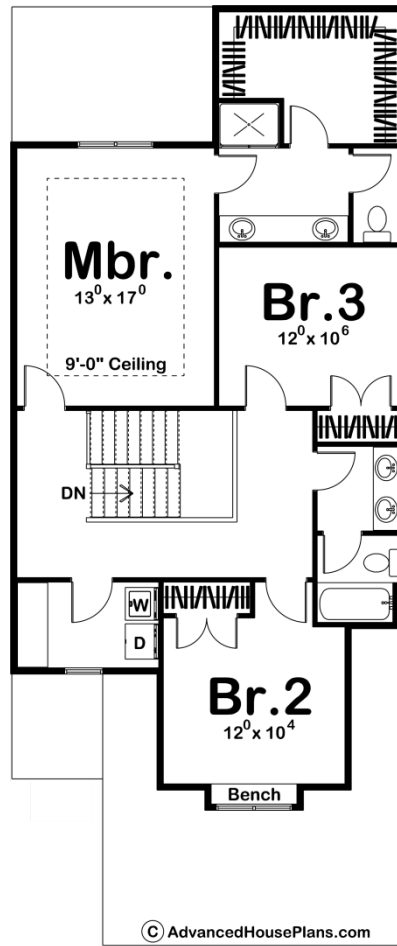



## Construction Specs

### Layout

Bedrooms	3
Bathrooms	3
Garage Bays	2

### Square Footage

Main Level	899 Sq. Ft.
Second Level	1053 Sq. Ft.
Garage	462 Sq. Ft.
Total Finished Area	1952 Sq. Ft.

### Exterior Dimensions

Width	26' 0"
Depth	62' 0"
Ridge Height	31' 0"
<i>Calculated from main floor line</i>	

### Default Construction Stats

*Stats are unique to the individual plan.*

Foundation Type	Basement
Exterior Wall Construction	2x4
Roof Pitches	8/12
Foundation Wall Height	9'
Main Wall Height	9'
Second Wall Height	8'

## Plan Description

At only 26 feet wide, this 1,962 sq. ft. 2-story house plan will give any small lot a huge personality. Just inside from the front covered stoop, guests are welcomed into the family room with its fireplace and views to a rear covered deck. The kitchen and breakfast area continue the open arrangement of the main floor for a surprisingly spacious feel. The kitchen itself offers a breakfast island workspace, generous counters and an adjacent walk-in pantry. The breakfast area is flooded with natural light and accesses the rear covered deck for expanded dining options. Just off the kitchen, a mudroom with pantry, bench, lockers, coat closet and handy catch-all area accesses the home's 2-car, front-load garage. The second level is host to all three bedrooms. The master suite has a 9-foot-high boxed ceiling and its bath area features a 2-sink vanity, compartmented toilet, shower and sizeable walk-in closet. Bedrooms 2 and 3 share a central hall bath.