

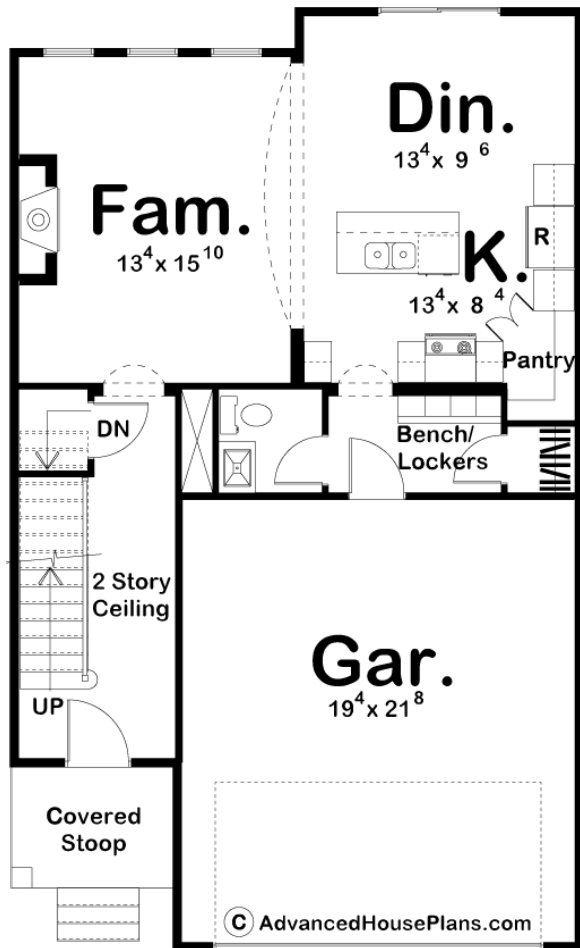

### 29312 - Newcastle Data Sheet

1645 SQ FT	3 BEDS	3 BATHS	2 BAYS	28' 0" WIDE	46' 0" DEEP
---------------	-----------	------------	-----------	----------------	----------------

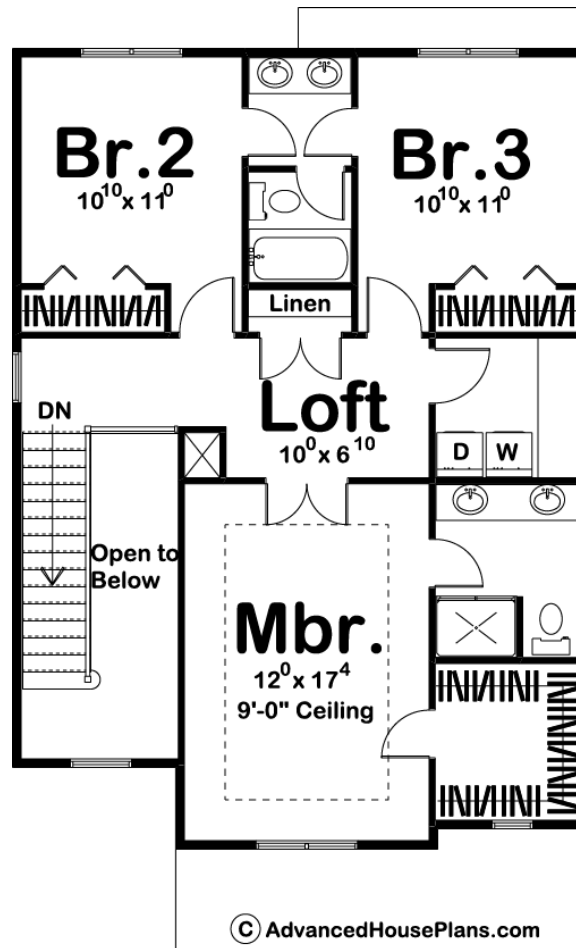



## Construction Specs

### Layout

Bedrooms	3
Bathrooms	3
Garage Bays	2

### Square Footage

Main Level	740 Sq. Ft.
Second Level	905 Sq. Ft.
Garage	435 Sq. Ft.
Total Finished Area	1645 Sq. Ft.

### Exterior Dimensions

Width	28' 0"
Depth	46' 0"
Ridge Height	31' 0"
<i>Calculated from main floor line</i>	

## Default Construction Stats

*Stats are unique to the individual plan.*

Foundation Type	Basement
Exterior Wall Construction	2x4
Roof Pitches	8/12
Foundation Wall Height	9'
Main Wall Height	9'
Second Wall Height	8'

## Plan Description

At only 28 feet wide, this charming 3-bedroom, 2-story house plan is the perfect choice for narrow lots, and it features a number of amenities usually found in much larger homes. Just inside from the front covered porch, a 2-story-high entry hall leads to the family room, which is warmed by a fireplace and brightened by a bank of windows to the rear. Gatherings are easily accommodated by the open arrangement between the great room, dining area and kitchen. The kitchen features an island work area and walk-in pantry. Just off the kitchen, a mud room with bench, lockers, coat closet and powder bath, intercepts clutter from the outside and accesses the 2-car garage. Upstairs, a central loft area introduces all three bedrooms. The master suite includes a roomy walk-in closet with a window. Bedrooms 2 and 3 share a Jack-n-Jill bath. An upstairs laundry area conveniently serves all bedrooms.