

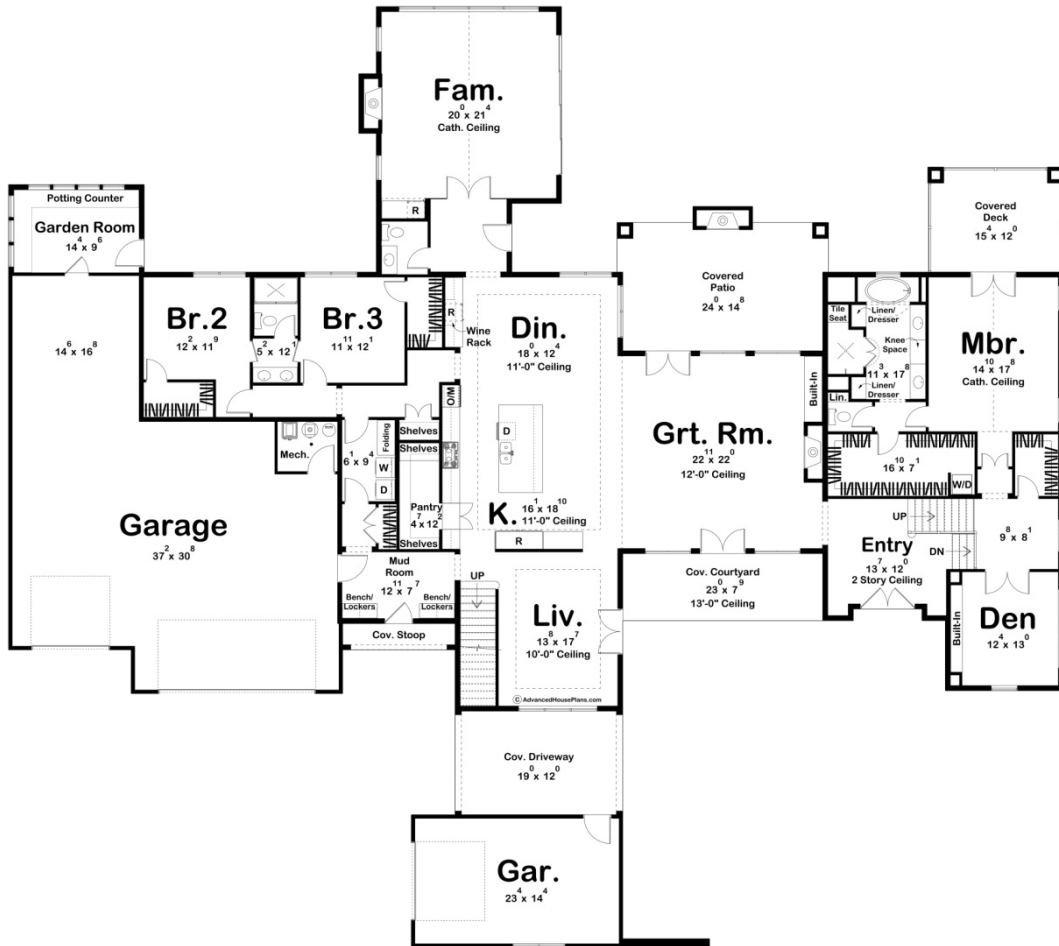

**30390 - Olive Flats Data Sheet**

4990 SQ FT	5 BEDS	5 BATHS	4 BAYS	120' 4" WIDE	107' 4" DEEP
---------------	-----------	------------	-----------	-----------------	-----------------

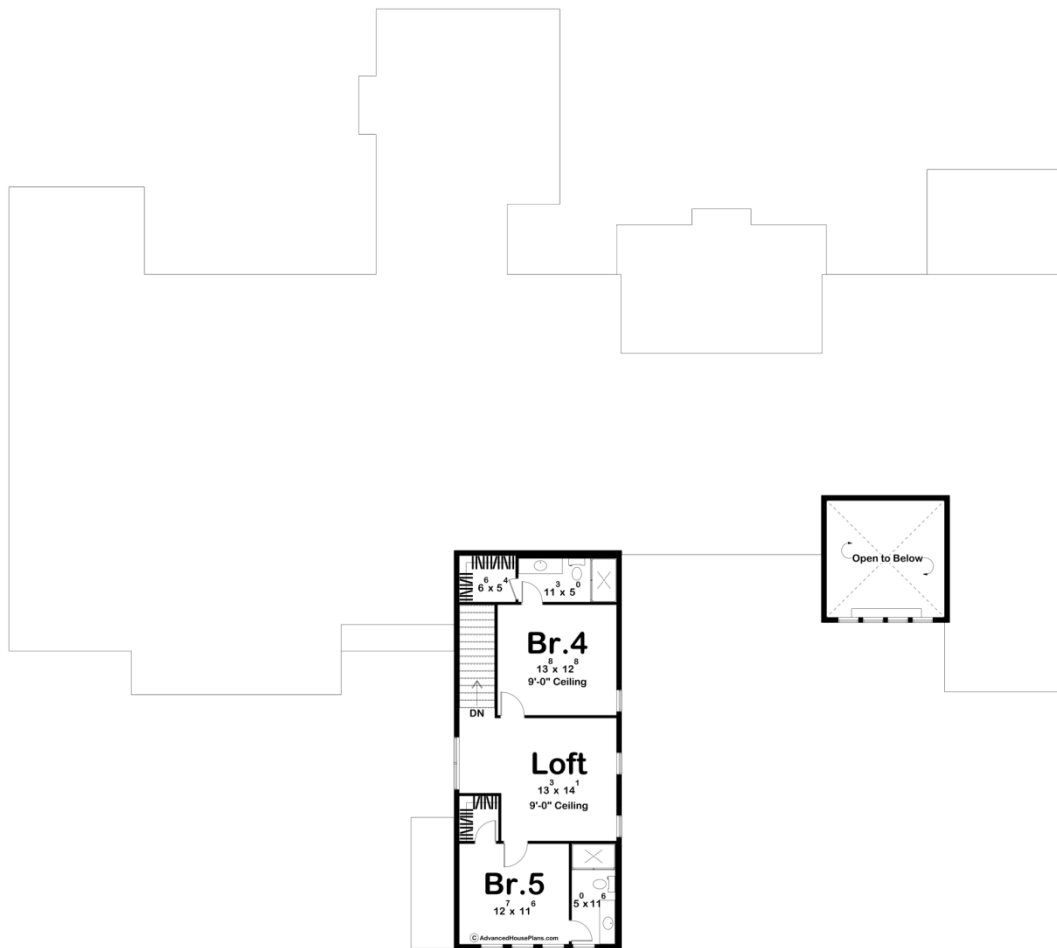



## Construction Specs

### Layout

Bedrooms	5
Bathrooms	5
Garage Bays	4

### Square Footage

Main Level	4175 Sq. Ft.
Second Level	815 Sq. Ft.
Covered Area	957 Sq. Ft.
Garage	1669 Sq. Ft.
Total Finished Area	4990 Sq. Ft.

### Exterior Dimensions

Width	120' 4"
Depth	107' 4"
Ridge Height	32' 0"
<i>Calculated from main floor line</i>	

### Default Construction Stats

*Stats are unique to the individual plan.*

Foundation Type	Slab
Exterior Wall Construction	2x6
Roof Pitches	Primary 10/12, Secondary 14/12, Secondary 8/12, Secondary 6/12
Main Wall Height	10'
Second Wall Height	8'

## Plan Description

Explore the Olive Flats, a luxurious, modern cottage-style house that effortlessly blends elegance, comfort, and functionality. This exquisite home plan features five spacious bedrooms, each designed as a private sanctuary filled with natural light, and five luxurious bathrooms. The four-car garage provides ample space for your vehicles and additional storage, ensuring convenience and style. The floor plan promotes open-concept living with a seamless flow between the kitchen, dining, and living areas, enhanced by high ceilings and large windows that create a bright, airy atmosphere and showcase beautiful views of the surrounding landscape. In the heart of the home is an expansive, state-of-the-art kitchen with a generous island for meal prep and casual dining, as well as plenty of storage, making it perfect for both everyday cooking and entertaining guests. The expansive outdoor living areas around the home are designed for both relaxation and entertainment. These spaces are perfect for hosting gatherings or enjoying a quiet evening outside. The Olive Flats is a modern cottage-style house plan that is the perfect blend of luxury and comfort, designed to create lasting memories and provide a cozy, upscale lifestyle.