

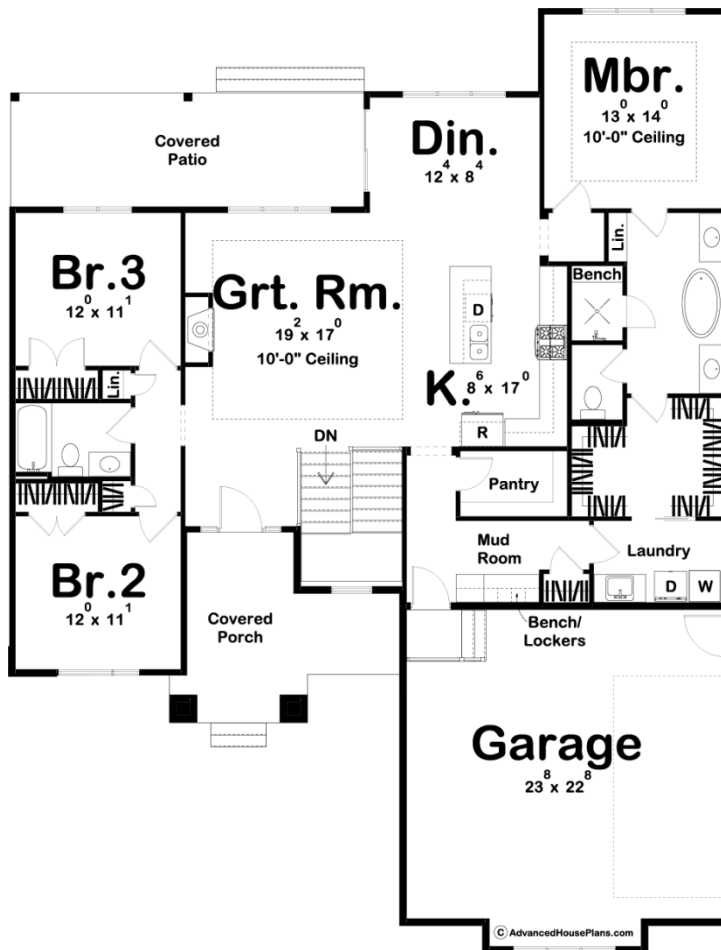

29809 - Pacific Falls Data Sheet

1813 SQ FT	3 BEDS	2 BATHS	2 BAYS	52' 0" WIDE	68' 0" DEEP
---------------	-----------	------------	-----------	----------------	----------------



Construction Specs

Layout

Bedrooms

Bathrooms	2
Garage Bays	2

Square Footage

Main Level	1813 Sq. Ft.
Garage	559 Sq. Ft.
Total Finished Area	1813 Sq. Ft.

Exterior Dimensions

Width	52' 0"
Depth	68' 0"
Ridge Height <i>Calculated from main floor line</i>	17' 0"

Default Construction Stats

Stats are unique to the individual plan.

Foundation Type	Basement
Exterior Wall Construction	2x4
Roof Pitches	4/12 Primary
Foundation Wall Height	9'
Main Wall Height	9'

Plan Description

An appealing covered front porch and a combination of stone, siding and wood give this 1 story house plan a modern look. Inside, guests are welcomed by a decorative ceiling and a fireplace in the open great room/ kitchen concept. The L-shaped kitchen and island adjoin the dining area, which opens onto a rear covered patio, where guests can mingle before dinner is served. A generously sized master suite is tucked away for privacy behind the kitchen and includes a tray ceiling. The well-appointed master bath includes a large whirlpool tub, shower, compartmented toilet, and walk-in closet with access to the laundry room. Two additional bedrooms occupy this 1 story house plan. This 1 story house plan also features a 2 car side load garage.