

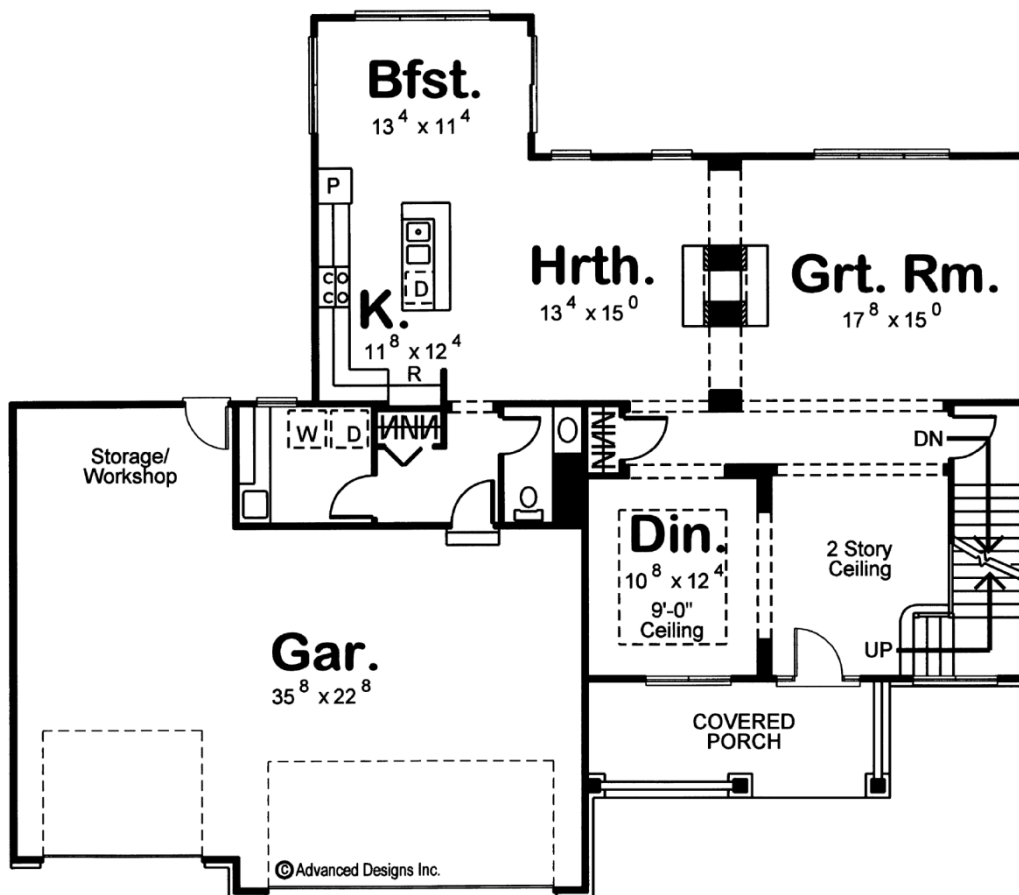

29180 - Patterson Data Sheet

2869 SQ FT	4 BEDS	4 BATHS	3 BAYS	64' 0" WIDE	55' 0" DEEP
---------------	-----------	------------	-----------	----------------	----------------

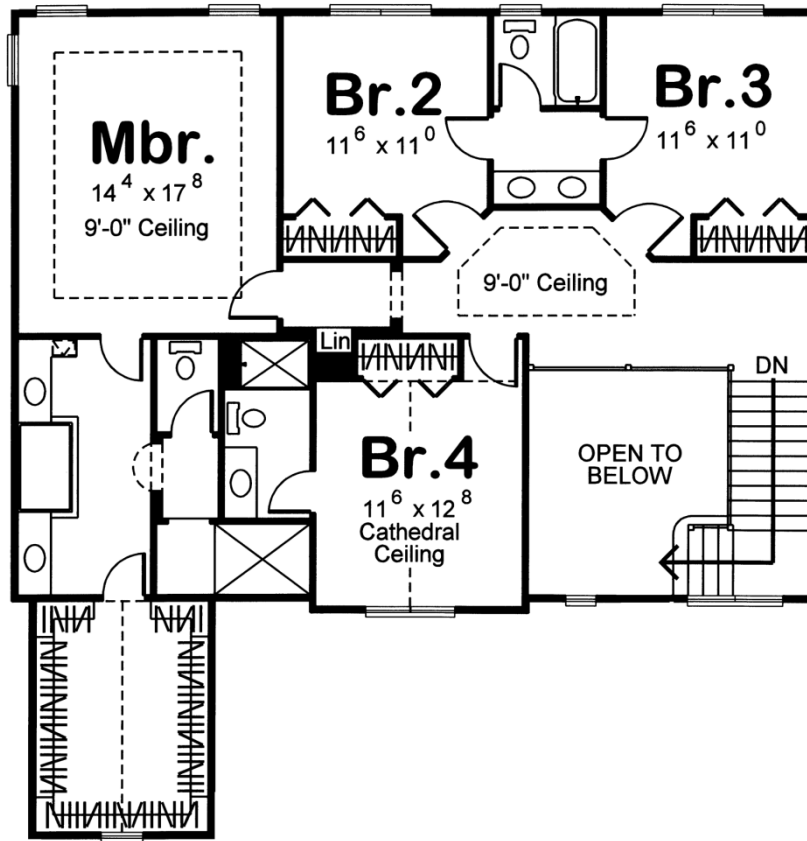



Construction Specs

Layout

Bedrooms	4
Bathrooms	4
Garage Bays	3

Square Footage

Main Level	1465 Sq. Ft.
Second Level	1404 Sq. Ft.
Garage	858 Sq. Ft.
Total Finished Area	2869 Sq. Ft.

Exterior Dimensions

Width	64' 0"
Depth	55' 0"
Ridge Height	30' 0"
<i>Calculated from main floor line</i>	

Default Construction Stats
Stats are unique to the individual plan.

Foundation Type	Basement
Exterior Wall Construction	2x4
Roof Pitches	8/12 F-B, 10/12 S-S
Foundation Wall Height	9'
Main Wall Height	9'
Second Wall Height	8'

Plan Description

29180 Patterson Traditional architectural style is enhanced by half-timbered detailing on this charming 4-bedroom, 2-story house plan. A covered front porch grants entrance, where guests are welcomed into a 2-story-high entry hall that adjoins the formal dining room. Further inside, the great room offers expansive views to the rear, while sharing a see-thru fireplace with the hearth room. The hearth room, breakfast area, and kitchen openly interact to create a comfortable gathering space. Just off the kitchen, a practical utility area includes a powder bath, coat closet and laundry room with counter space and soaking sink. This area accesses the 3-car garage, which features extra space for storage or a workshop. Upstairs, the master suite boasts a sprawling bath area with his-and-her vanities, soaking tub, walk-in shower, compartmented toilet and large walk-in closet. Bedroom 4 is highlighted by a cathedral ceiling and has its own private bath. Bedrooms 2 and 3 share a Jack-n-Jill bath. The second-level landing offers views to the entry hall below.

advanced house plans