

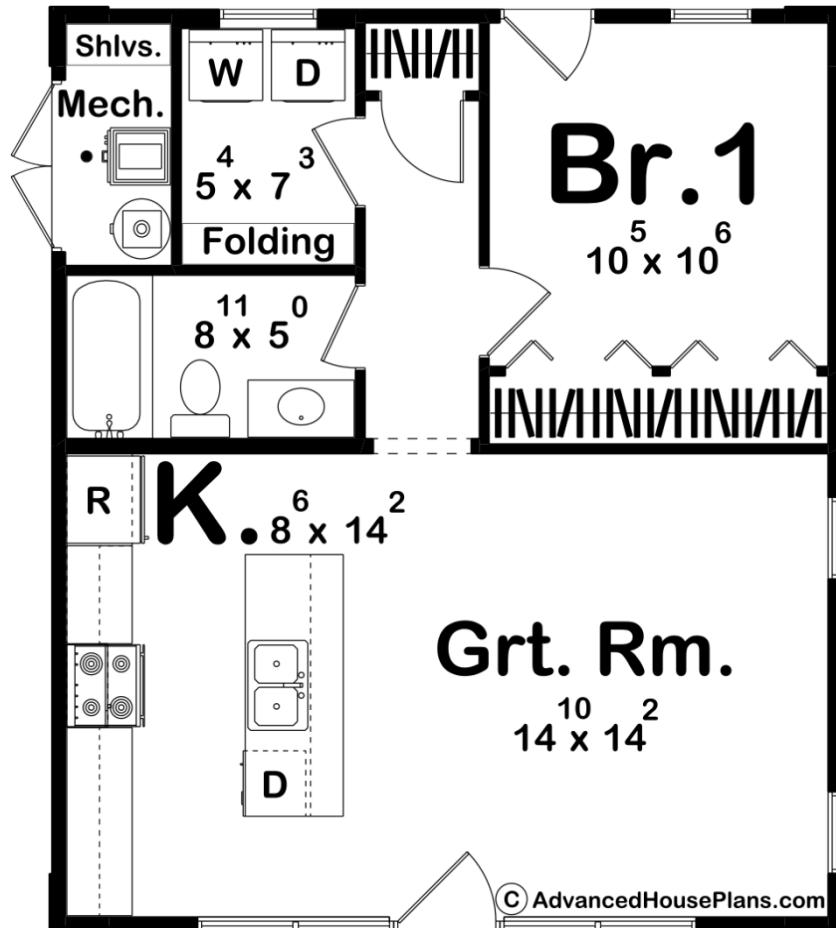

**30552 - Petaluma Data Sheet**

648 SQ FT	1 BEDS	1 BATHS	0 BAYS	24' 0" WIDE	28' 0" DEEP
--------------	-----------	------------	-----------	----------------	----------------



**Construction Specs**

Layout

Bedrooms

Bathrooms

1

### Square Footage

Main Level

648 Sq. Ft.

Total Finished Area

648 Sq. Ft.

### Exterior Dimensions

Width

24' 0"

Depth

28' 0"

Ridge Height

*Calculated from main floor line*

11' 0"

### Default Construction Stats

*Stats are unique to the individual plan.*

Foundation Type

Slab

Exterior Wall Construction

2x4

Roof Pitches

Flat

Main Wall Height

9'

## Plan Description

Introducing the Petaluma, your dream modern cottage-style ADU (Accessory Dwelling Unit) – a perfect blend of charm, functionality, and contemporary design. This one-bedroom, one-bathroom gem offers a cozy, yet spacious living environment with an open-concept layout that maximizes space and light. The open floor plan effortlessly connects the living room and kitchen, creating an airy and spacious feel. Large windows and sliding glass doors bathe the interior in natural light, enhancing the sense of openness and connection to the outdoors. This ADU combines the best of cozy cottage charm with contemporary design and amenities. It's the perfect choice for those seeking a stylish, functional, and inviting living space in a compact footprint. Make this dream home yours and enjoy the perfect blend of comfort and modern living.