

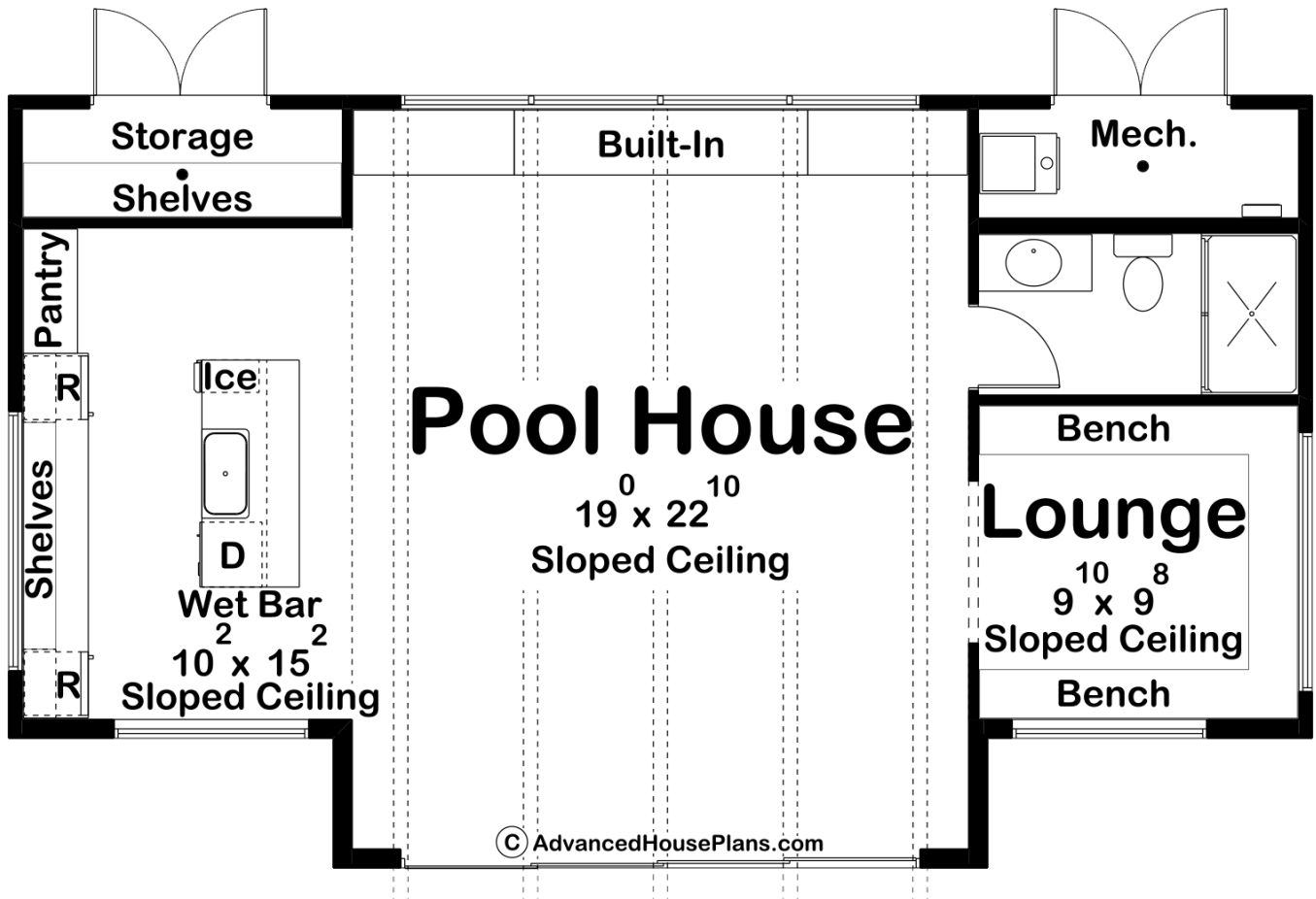

30263 - Pikewood Data Sheet

792 SQ FT	0 BEDS	1 BATHS	0 BAYS	40' 0" WIDE	23' 8" DEEP
--------------	-----------	------------	-----------	----------------	----------------



Construction Specs

Layout

Bathrooms

Square Footage

Main Level	792 Sq. Ft.
Total Finished Area	792 Sq. Ft.

Exterior Dimensions

Width	40' 0"
Depth	23' 8"
Ridge Height <i>Calculated from main floor line</i>	16' 5"

Default Construction Stats

Stats are unique to the individual plan.

Foundation Type	Slab
Exterior Wall Construction	2x4
Roof Pitches	2/12 Primary
Main Wall Height	9'

Plan Description

The Pikewood is a modern pool house with small square footage, but a big luxury feel. The large glass and wood accents make you want to step inside this pool house. On the inside you will find tall sloped ceilings throughout. In the main room, there are exposed beams running from front to back. There are built-ins on the rear wall for your entertainment set up. The wet bar is loaded with two under counter refrigerators, a pantry, and an island with a dishwasher, sink, and ice maker if you please. On the other side is a bathroom and a lounge area with bench seating on three sides. A slat accent wall separates this from the main seating area. The rear of the pool house has two separate storage spaces for all of the equipment needed to run the best pool house.