

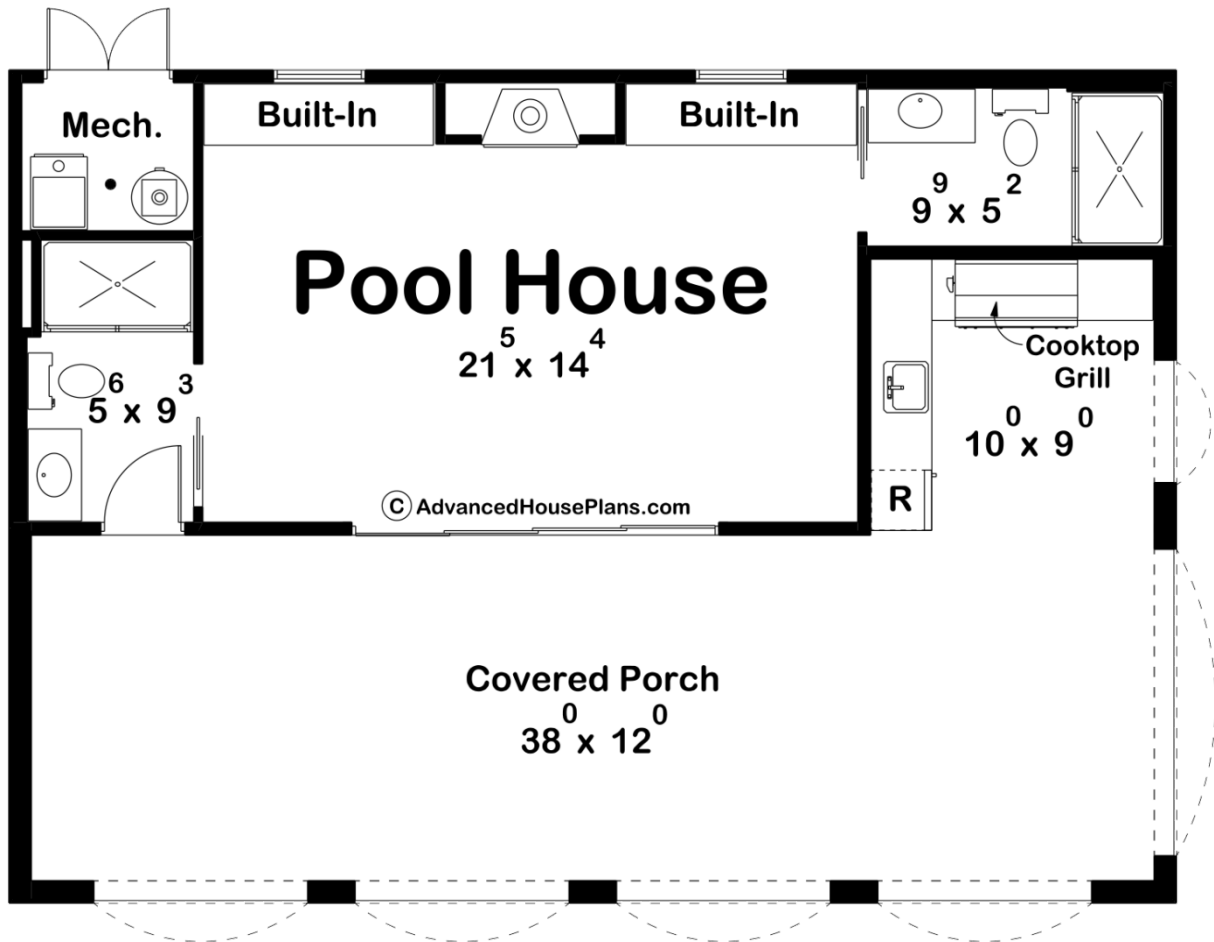

30506 - Ruhlman Data Sheet

453 SQ FT	0 BEDS	2 BATHS	0 BAYS	38' 0" WIDE	27' 0" DEEP
--------------	-----------	------------	-----------	----------------	----------------



Construction Specs

Layout

Bathrooms

Square Footage

Main Level	453 Sq. Ft.
Covered Area	546 Sq. Ft.
Total Finished Area	453 Sq. Ft.

Exterior Dimensions

Width	38' 0"
Depth	27' 0"
Ridge Height <i>Calculated from main floor line</i>	16' 3"

Default Construction Stats

Stats are unique to the individual plan.

Foundation Type	Slab
Exterior Wall Construction	2x4
Main Wall Height	9'

Plan Description

Welcome to this mediterranean pool house plan: The Ruhlman. This pool house plan has an exterior that boasts stucco along with clay tile roofing. Arched openings lead guests into the covered porch space that includes an outdoor kitchen. Entering the pool house, you are greeted by an open hang out space that includes a fireplace alongside built-in shelves. Two bathrooms, each including skylights, are incorporated into this pool house plan. The Ruhlman Pool House is a perfect space for entertaining guests on a hot summer day.