

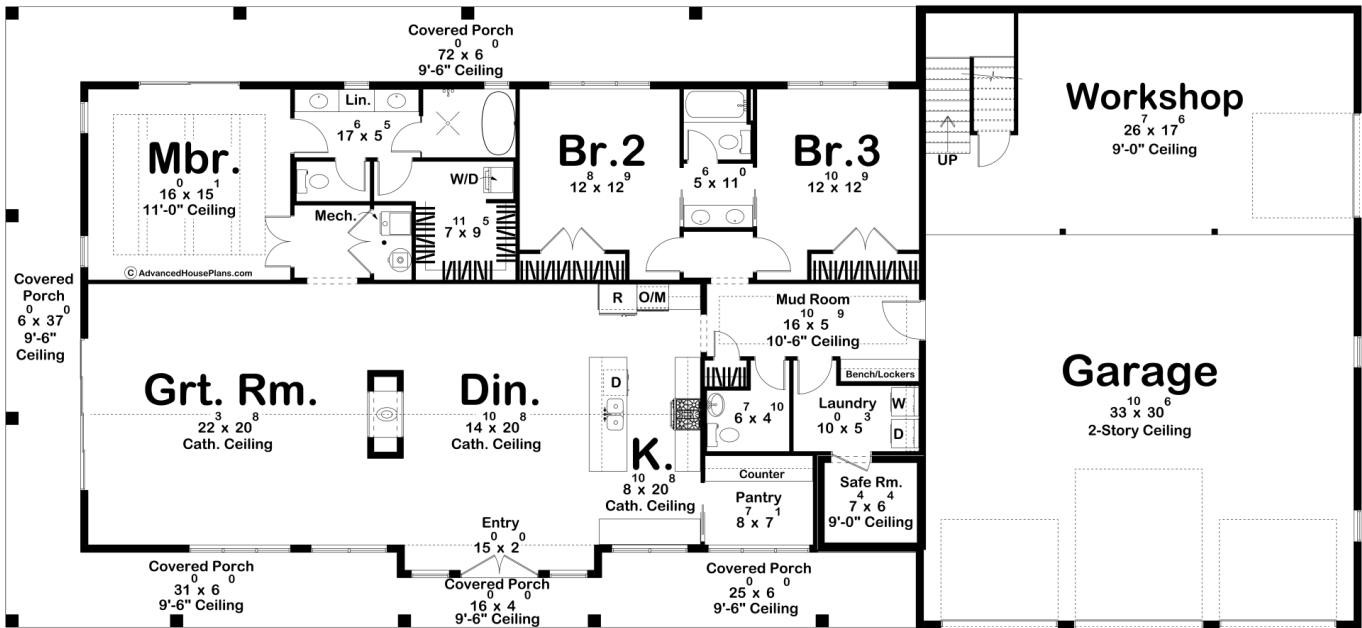

**30649 - Sagebrush Data Sheet**

|               |           |            |           |                 |                |
|---------------|-----------|------------|-----------|-----------------|----------------|
| 2436<br>SQ FT | 3<br>BEDS | 3<br>BATHS | 3<br>BAYS | 107' 0"<br>WIDE | 49' 0"<br>DEEP |
|---------------|-----------|------------|-----------|-----------------|----------------|

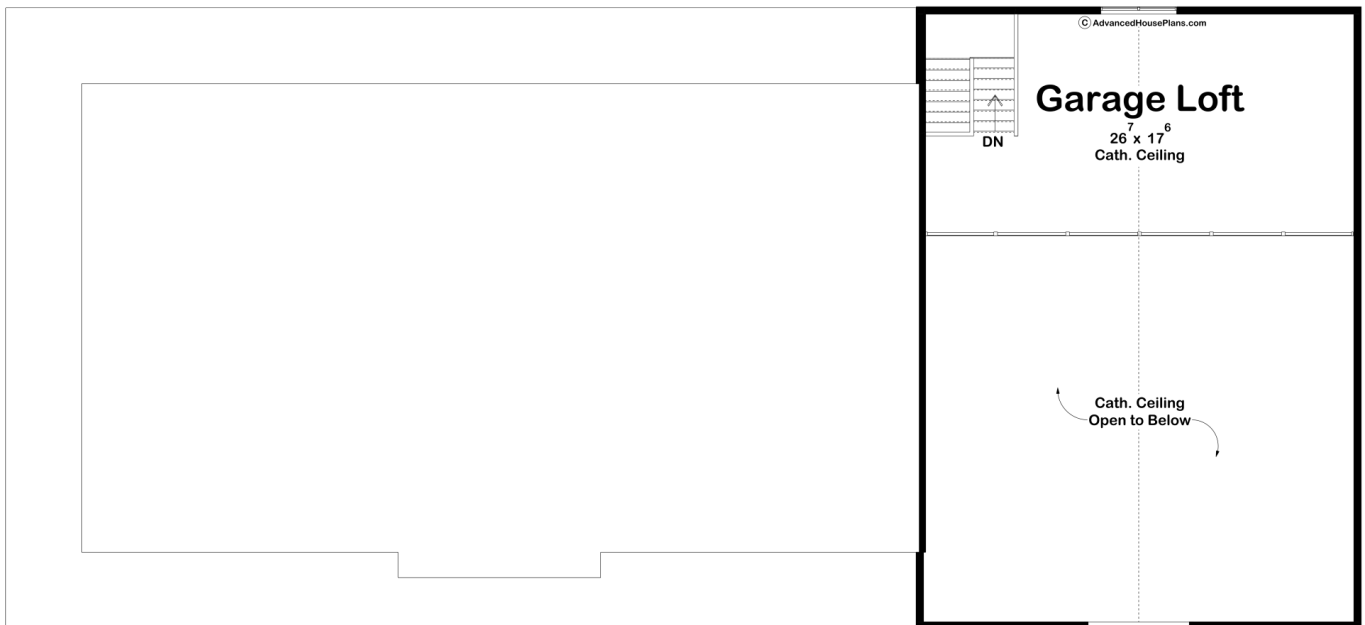



## Construction Specs

### Layout

|             |   |
|-------------|---|
| Bedrooms    | 3 |
| Bathrooms   | 3 |
| Garage Bays | 3 |

### Square Footage

|                     |              |
|---------------------|--------------|
| Main Level          | 2436 Sq. Ft. |
| Covered Area        | 1054 Sq. Ft. |
| Garage              | 1067 Sq. Ft. |
| Total Finished Area | 2436 Sq. Ft. |

### Exterior Dimensions

|  |         |
|--|---------|
| Width                                  | 107' 0" |
| Depth                                  | 49' 0"  |
| Ridge Height                           | 28' 5"  |
| <i>Calculated from main floor line</i> |         |

## Default Construction Stats

*Stats are unique to the individual plan.*

|                            |   |
|----------------------------|---|
| Foundation Type            | Slab                                      |
| Exterior Wall Construction | 2x6                                       |
| Roof Pitches               | Primary 8/12, Secondary 10/12, 3/12, 6/12 |
| Main Wall Height           | 10'                                       |
| Second Wall Height         | 6'  |

## Plan Description

This single-story barndominium-style house plan combines rustic charm with modern functionality. The exterior features classic board-and-batten siding complemented by steel panel roofing and wood accents, giving it a cozy yet durable feel. A massive wrap-around porch encircles the home, perfect for outdoor living and relaxation. The front of the home includes a three-car garage with a spacious workshop, and above the garage, an upstairs loft serves as a lounge area overlooking the entire garage space. Inside, the heart of the home is an expansive open-concept living area where the kitchen, dining room, and great room flow seamlessly under a grand cathedral ceiling. A dual-sided fireplace divides the dining room and the great room, providing warmth and ambiance to both spaces. The home offers three bedrooms, including a well-appointed master suite. A key feature is the safe room, providing security and peace of mind. This barndominium plan offers a perfect balance of rustic aesthetics and modern convenience, making it an ideal home for living.