

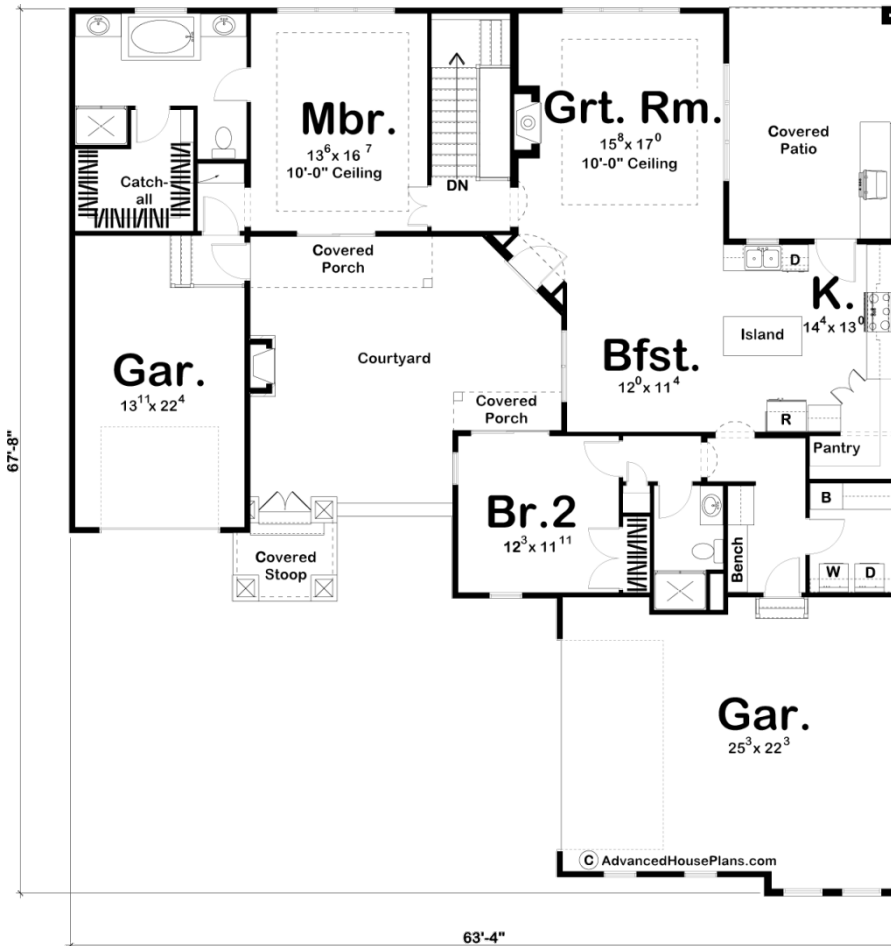

## 29333 - Santa Rosa Data Sheet

1709 SQ FT	2 BEDS	2 BATHS	3 BAYS	64' 0" WIDE	68' 0" DEEP
---------------	-----------	------------	-----------	----------------	----------------



## Construction Specs

Layout

Bedrooms

Bathrooms	2
-----------	---

Garage Bays	3
-------------	---

### Square Footage

Main Level	1709 Sq. Ft.
------------	--------------

Garage	870 Sq. Ft.
--------	-------------

Total Finished Area	1709 Sq. Ft.
---------------------	--------------

### Exterior Dimensions

Width	64' 0"
-------	--------

Depth	68' 0"
-------	--------

Ridge Height	21' 0"
--------------	--------

*Calculated from main floor line*

### Default Construction Stats

*Stats are unique to the individual plan.*

Foundation Type	Basement
-----------------	----------

Exterior Wall Construction	2x4
----------------------------	-----

Roof Pitches	6/12
--------------	------

Foundation Wall Height	9'
------------------------	----

Main Wall Height	9'
------------------	----

## Plan Description

With a unique floor plan and a stunning Mediterranean facade, the Santa Rosa is a head-turner with many great features. A courtyard plan, the house wraps around an exterior space that will be a favorite place to relax outside. It allows for a private yet enchanting entrance to the home and gives you daylight and views from both the front and the rear of the house from the master suite. Distinct to this plan is the single car garage that enters directly into the master bedroom. This allows you the freedom to conceal your stored items with a more private garage. The master suite has his and her vanities, a shower and whirlpool tub, and a generous walk-in closet. The plan also features a large covered patio, large windows throughout the plan for great views and light, and open living spaces.