

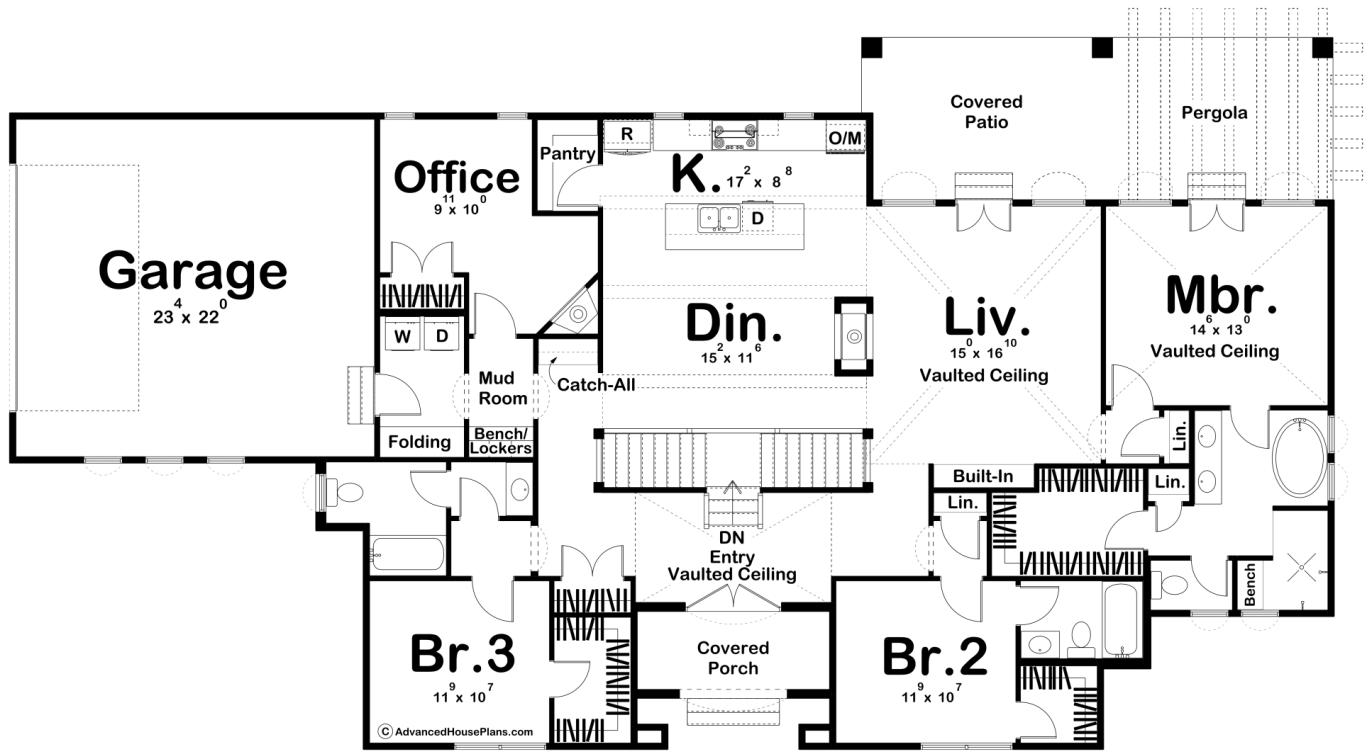

**30176 - Seville Data Sheet**

2192 SQ FT	3 BEDS	3 BATHS	2 BAYS	86' 0" WIDE	46' 4" DEEP
---------------	-----------	------------	-----------	----------------	----------------



**Construction Specs**

Layout

Bedrooms

Bathrooms	3
-----------	---

Garage Bays	2
-------------	---

### Square Footage

Main Level	2192 Sq. Ft.
------------	--------------

Covered Area	389 Sq. Ft.
--------------	-------------

Garage	555 Sq. Ft.
--------	-------------

Total Finished Area	2192 Sq. Ft.
---------------------	--------------

### Exterior Dimensions

Width	86' 0"
-------	--------

Depth	46' 4"
-------	--------

Ridge Height	17' 11"
<i>Calculated from main floor line</i>	

### Default Construction Stats

*Stats are unique to the individual plan.*

Foundation Type	Basement
-----------------	----------

Exterior Wall Construction	2x4
----------------------------	-----

Roof Pitches	4/12 Primary
--------------	--------------

Foundation Wall Height	9'
------------------------	----

Main Wall Height	9'
------------------	----

## Plan Description

The Seville plan is a Mediterranean style home. It is perfect for those with a European taste and a craving for luxury. The exterior of this home gives a great curb appeal with the different textures such as stucco and stone. Walk up the path to the front door, and you're welcomed with a covered porch leading into a beautiful entryway. Step inside to get a straight view of the dining room, or head down either side of the hallway to explore what this home has to offer. Both additional bedrooms can be found on the front side of the house with individual bathrooms and walk-in closets. The kitchen, living, and dining rooms are all connected, making the space open, yet also including a two-way fireplace for separation. The kitchen also has a gorgeous breakfast bar and a large walk-in pantry. The master suite can be found in connection to the living room and outdoor pergola, being a great spot to step out after a meal and watch the sunset. The master suite also includes a soaking tub, double vanity, and walk-in closet. Head to the opposite side of the home to find an additional space for an office, followed by another fireplace, as well as a mudroom and laundry area that leads out to the spacious two-car garage.