

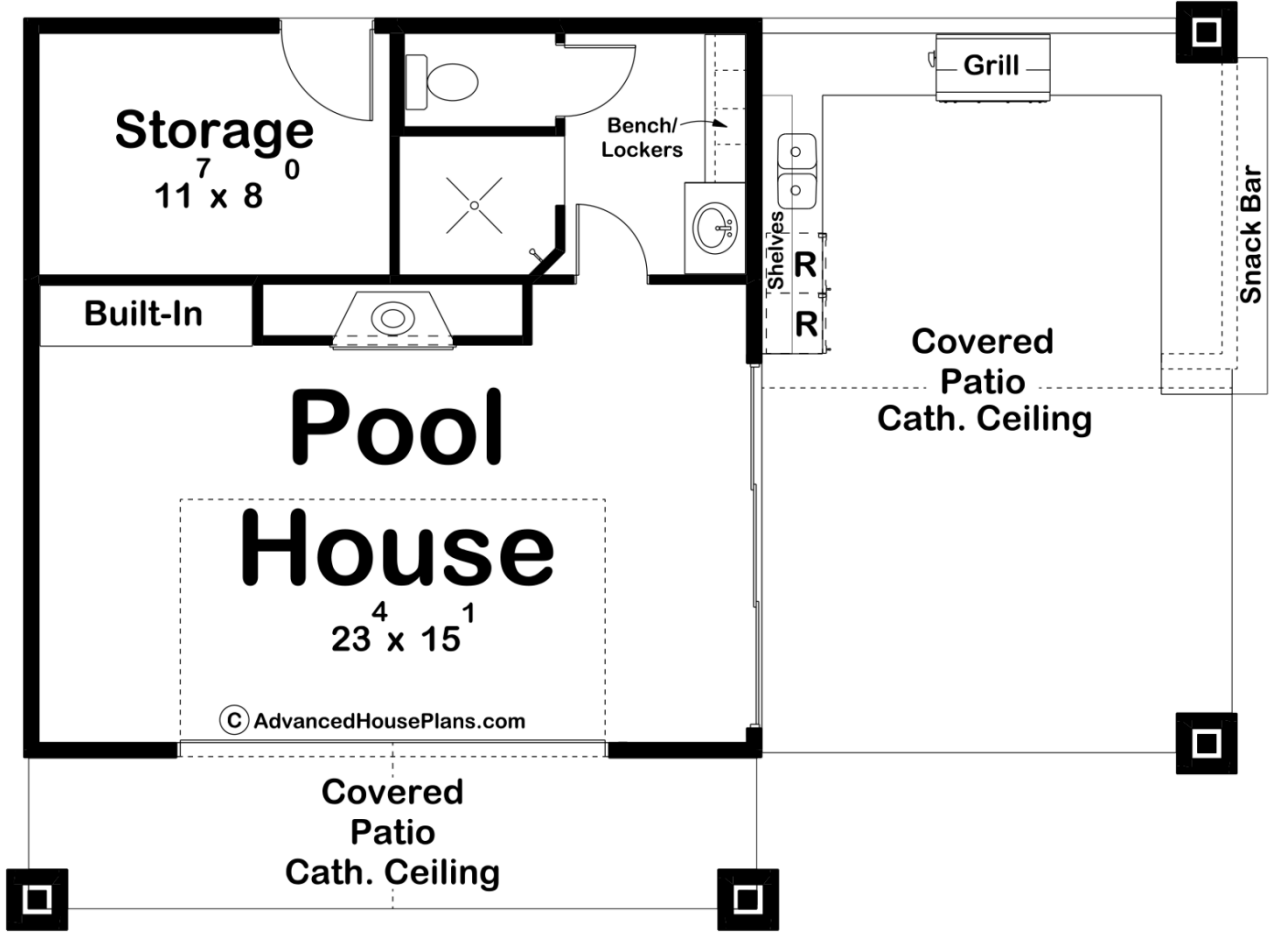

**30261 - Steamboat Springs Data Sheet**

477 SQ FT	0 BEDS	1 BATHS	0 BAYS	40' 3" WIDE	30' 3" DEEP
--------------	-----------	------------	-----------	----------------	----------------



**Construction Specs**

Layout

Bathrooms

## Square Footage

Main Level	477 Sq. Ft.
Covered Area	486 Sq. Ft.
Total Finished Area	477 Sq. Ft.

## Exterior Dimensions

Width	40' 3"
Depth	30' 3"
Ridge Height <i>Calculated from main floor line</i>	15' 7"

## Default Construction Stats

*Stats are unique to the individual plan.*

Foundation Type	Slab
Exterior Wall Construction	2x4
Roof Pitches	6/12 Primary
Main Wall Height	9'

## Plan Description

The Steamboat Springs is a pool house with so much character. The exposed rafters and large decorative gable trusses give this structure amazing curb appeal. Under the large covered porch you will find a kitchen equipped with a built-in grill, a sink, and dual refrigerators. There is a snack bar as well. On the inside you will find a large sitting area with a fireplace and built-ins. There is also a bathroom with a walk-in shower. On the rear side of the pool house is access to a storage room. This is great for pool equipment and toys.