

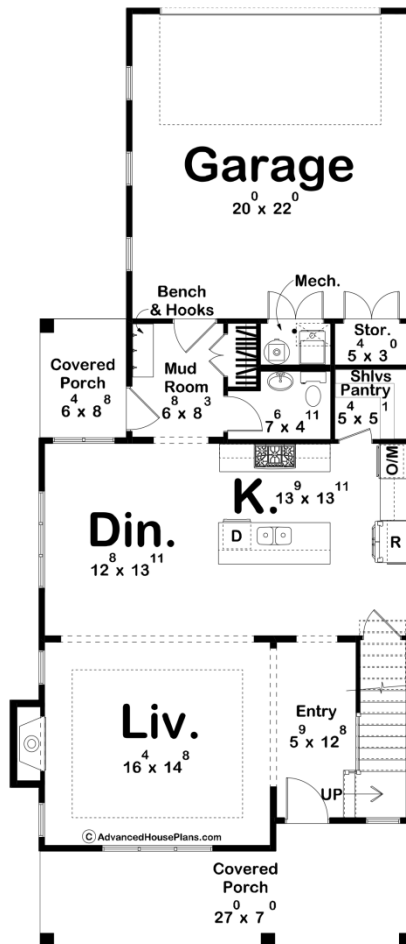

30568 - Sugarcrest Data Sheet

1908 SQ FT	3 BEDS	3 BATHS	1 BAYS	29' 0" WIDE	67' 8" DEEP
---------------	-----------	------------	-----------	----------------	----------------

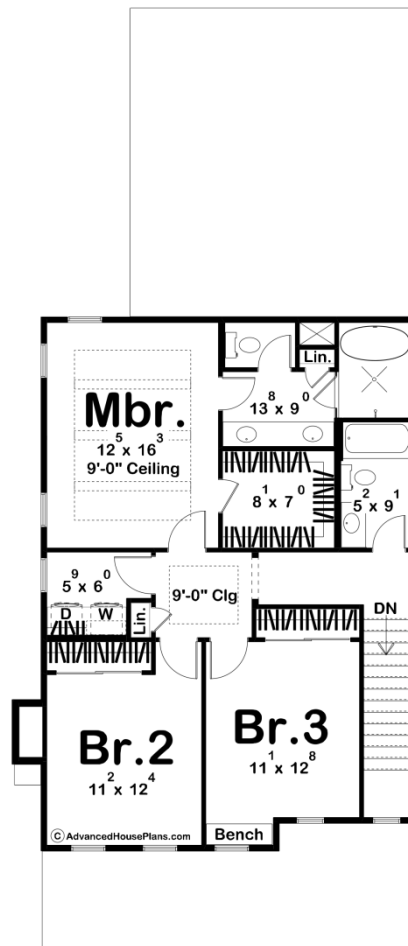



Construction Specs

Layout

Bedrooms	3
Bathrooms	3
Garage Bays	1

Square Footage

Main Level	942 Sq. Ft.
Second Level	966 Sq. Ft.
Covered Area	264 Sq. Ft.
Garage	462 Sq. Ft.
Total Finished Area	1908 Sq. Ft.

Exterior Dimensions

Width	29' 0"
Depth	67' 8"
Ridge Height	27' 9"
<i>Calculated from main floor line</i>	

Default Construction Stats

Stats are unique to the individual plan.

Foundation Type	Slab
Exterior Wall Construction	2x4
Roof Pitches	Primary 6/12, Secondary 10/12, 4/12
Main Wall Height	9'
Second Wall Height	8'

Plan Description

Discover your dream home with our newest Modern Farmhouse plan, "Sugarcrest". This beautifully designed two-story residence effortlessly blends timeless charm with modern functionality. From the moment you arrive, you'll be captivated by the striking combination of board and batten and lap siding, complemented by a delightful stone chimney that adds a touch of elegance. Step onto the inviting covered front porch, complete with charming columns, where you can relax and enjoy the view. Inside, you'll find a spacious and thoughtfully laid-out interior with a finished 1908 sq. ft. The open-concept design integrates the kitchen, living, and dining areas, creating a seamless flow that's perfect for entertaining and daily family life. Upstairs, you'll find 3 well-appointed bedrooms and 3 bathrooms, ensuring ample space and privacy for everyone. The rear of the home features a convenient 2-car garage and an alternative covered porch entry, providing additional functionality and ease of access. Sugarcrest offers the perfect blend of style and practicality, making it an ideal choice for those who appreciate classic farmhouse charm with a modern twist!