

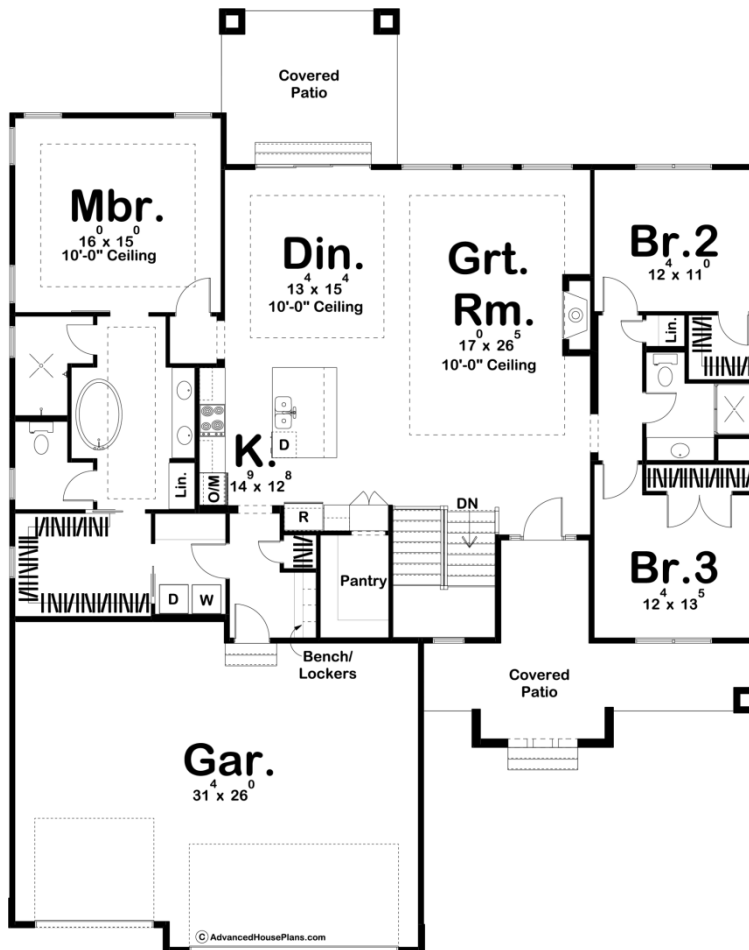

## 29675 - Sunset Ridge Data Sheet

2105 SQ FT	3 BEDS	2 BATHS	3 BAYS	58' 0" WIDE	73' 0" DEEP
---------------	-----------	------------	-----------	----------------	----------------



## Construction Specs

Layout

Bedrooms

Bathrooms	2
-----------	---

Garage Bays	3
-------------	---

### Square Footage

Main Level	2105 Sq. Ft.
------------	--------------

Garage	772 Sq. Ft.
--------	-------------

Total Finished Area	2105 Sq. Ft.
---------------------	--------------

### Exterior Dimensions

Width	58' 0"
-------	--------

Depth	73' 0"
-------	--------

### Default Construction Stats

*Stats are unique to the individual plan.*

Foundation Type	Basement
-----------------	----------

Exterior Wall Construction	2x4
----------------------------	-----

Roof Pitches	6/12 Primary
--------------	--------------

Foundation Wall Height	9'
------------------------	----

Main Wall Height	9'
------------------	----

## Plan Description

Classic Modern styling is accented by a tasteful blend of textures on this 1-story house plan. Inside, guests are treated to open views throughout much of the home's living space. Tall ceiling details define the outer boundary of the great room area with its fireplace and large windows to the back yard. The kitchen and dining area lie open to the great room and feature an island workspace and a walk-in pantry. From this area, a rear covered patio is accessible. A few steps from the kitchen can also lead to a generously sized laundry room with a folding counter. Just outside the laundry room, a mud area with built-in bench and coat closet offers access to the home's 3-car garage. The master is situated for privacy and designed for comfort. The bath area features dual sinks, compartmented toilet, a walk-in shower, and an oversized walk-in closet. Bedroom #2 and 3 are located on the other side of the home and share a convenient hall bath.