

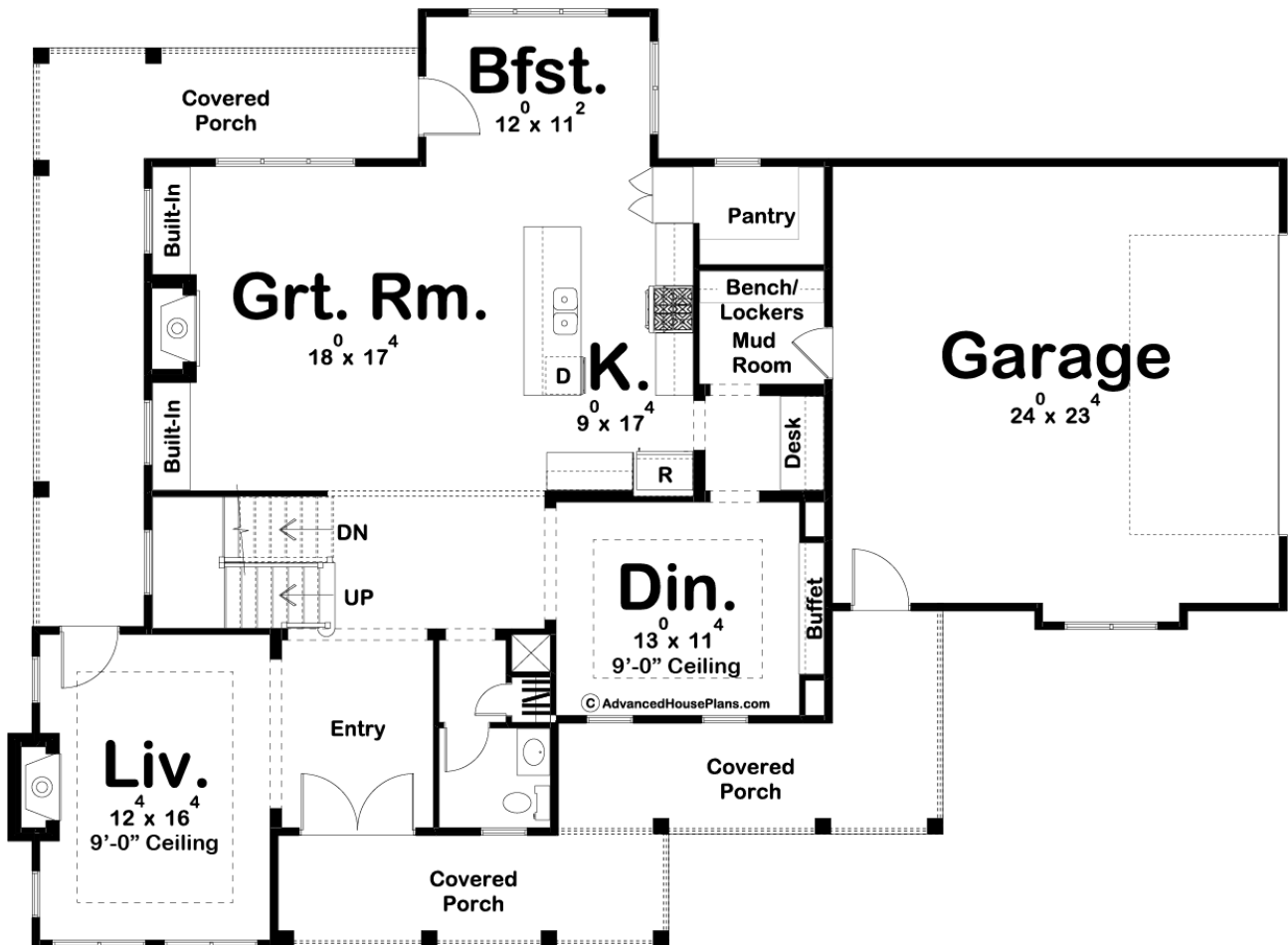

29812 - Thomasville Data Sheet

2784 SQ FT	4 BEDS	4 BATHS	2 BAYS	68' 0" WIDE	50' 0" DEEP
---------------	-----------	------------	-----------	----------------	----------------

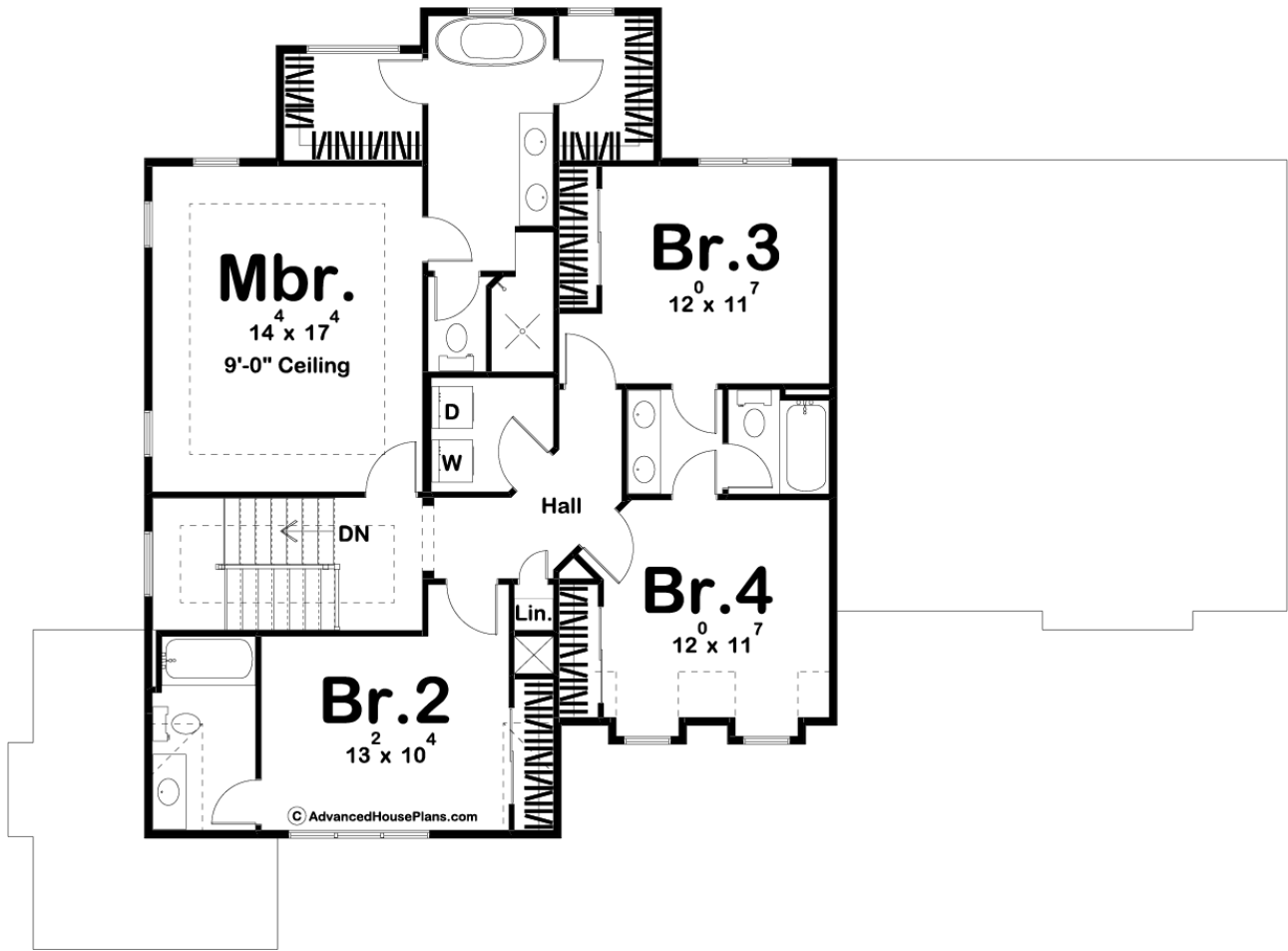



Construction Specs

Layout

Bedrooms	4
Bathrooms	4
Garage Bays	2

Square Footage

Main Level	1466 Sq. Ft.
Second Level	1318 Sq. Ft.
Garage	584 Sq. Ft.
Total Finished Area	2784 Sq. Ft.

Exterior Dimensions

Width	68' 0"
Depth	50' 0"

Default Construction Stats

Stats are unique to the individual plan.

Foundation Type	Basement
-----------------	----------

Exterior Wall Construction	2x4
Roof Pitches	8/12 Primary, 4/12 3/12 10/12 Secondary
Foundation Wall Height	9'
Main Wall Height	9'
Second Wall Height	8'

Plan Description

Our Thomasville plan has wonderful southern charm. On the exterior, there is a large covered porch that wraps around the house. Inside, you'll find a well thought out floor plan. Immediately inside the home, a beautiful entryway is flanked by a cozy living room that is warmed by a fireplace. Further, into the home, there is a great open layout of the kitchen, breakfast nook, and great room. The great room is also warmed by a fireplace that is flanked by built-in bookshelves. The kitchen includes a large island and a walk-in pantry. You will also find a formal dining room with a built-in buffet right off the entry and kitchen. The breakfast nook exits the house on the rear to the covered porch. Upstairs you will find 4 bedrooms including the wonderful master suite. The master suite has a decorative tray ceiling and includes a soaking tub, enclosed toilet, his/her vanities, and his/her walk-in closets. Bedrooms 3 and 4 share a jack and jill bathroom while bedroom 2 has its own bathroom. Back on the main level, the house's 2 car side load garage accesses the home through a mudroom that is complete with a bench and lockers.