

ADVANCED
HOUSE PLANS

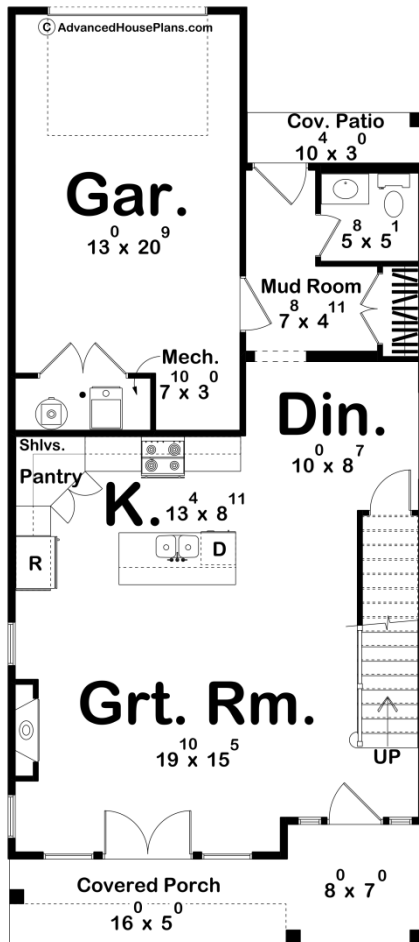

30556 - Thrasher Data Sheet

1638 SQ FT	3 BEDS	3 BATHS	1 BAYS	24' 0" WIDE	54' 0" DEEP
---------------	-----------	------------	-----------	----------------	----------------



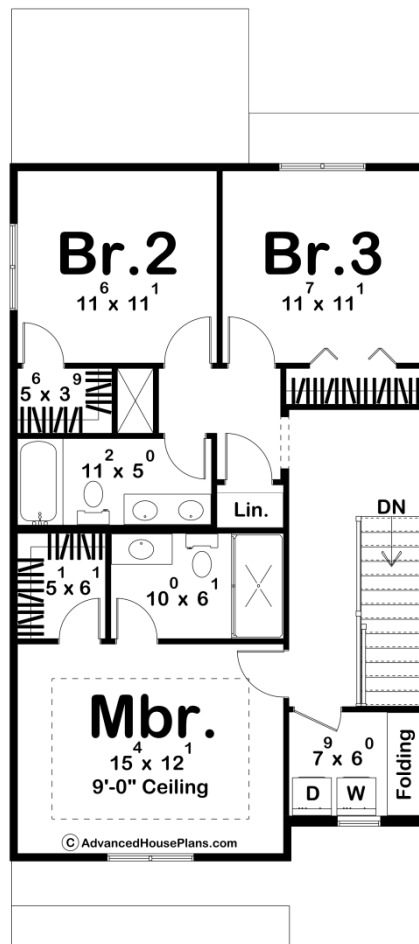

Construction Specs

Layout

Bedrooms	3
Bathrooms	3
Garage Bays	1

Square Footage

Main Level	740 Sq. Ft.
Second Level	898 Sq. Ft.
Covered Area	130 Sq. Ft.
Garage	304 Sq. Ft.
Total Finished Area	1638 Sq. Ft.

Exterior Dimensions

Width	24' 0"
Depth	54' 0"
Ridge Height	27' 4"
<i>Calculated from main floor line</i>	

Default Construction Stats

Stats are unique to the individual plan.

Foundation Type	Slab
Exterior Wall Construction	2x4
Roof Pitches	Primary 8/12
Main Wall Height	9'
Second Wall Height	8'

Plan Description

This two-story traditional-style home is perfect for narrow lots, featuring classic lap siding, decorative trim details, and hipped roofs that exude timeless charm. A welcoming covered front porch invites you into the home, while the rear covered patio, located next to the rear-entry one-car garage, provides a cozy outdoor living space. The first floor offers an open and functional layout with a comfortable living area that flows seamlessly into the kitchen and dining spaces. The kitchen is thoughtfully designed with ample counter space and modern amenities, ideal for both daily living and entertaining. A convenient bathroom and a small mudroom complete the main level, adding practicality to the design. Upstairs, the second floor is dedicated to private family spaces. The master bedroom features a walk-in closet and an en-suite bathroom. Two additional bedrooms provide flexibility for family or guests and share a well-appointed full bathroom. This home is the perfect blend of charm, style, and functionality, making it an excellent choice for families seeking comfort and efficiency in a compact yet elegant design.