

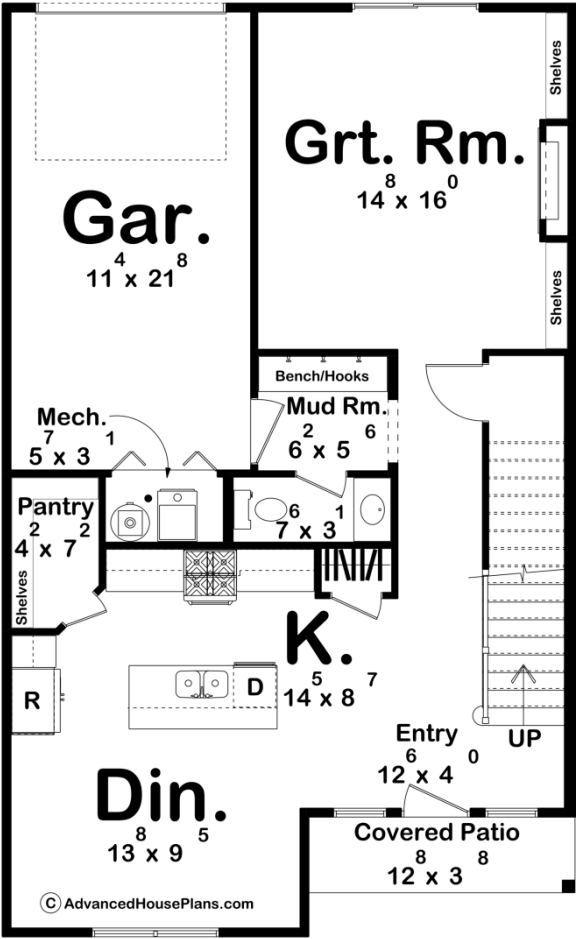

30611 - Trailwood Data Sheet

1916 SQ FT	3 BEDS	3 BATHS	1 BAYS	27' 0" WIDE	44' 0" DEEP
---------------	-----------	------------	-----------	----------------	----------------

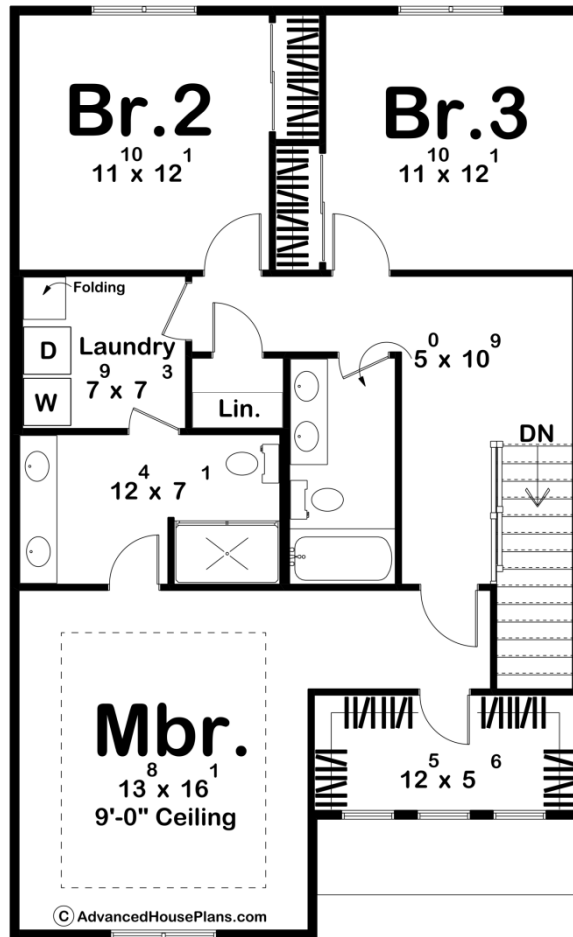



## Construction Specs

### Layout

Bedrooms	3
Bathrooms	3
Garage Bays	1

### Square Footage

Main Level	841 Sq. Ft.
Second Level	1075 Sq. Ft.
Covered Area	46 Sq. Ft.
Garage	257 Sq. Ft.
Total Finished Area	1916 Sq. Ft.

### Exterior Dimensions

Width	27' 0"
Depth	44' 0"
Ridge Height	28' 11"
<i>Calculated from main floor line</i>	

**Default Construction Stats**  
*Stats are unique to the individual plan.*

Foundation Type	Slab
Exterior Wall Construction	2x4
Roof Pitches	Primary 6/12, Secondary 8/12
Main Wall Height	9'
Second Wall Height	8'

**Plan Description**

Welcome to the Trailwood, a beautiful 3-bedroom, 3-bath traditional-style home. On the main floor, you'll find a mudroom attached to the garage, complete with a bench and hooks for easy storage. The great room features an electric fireplace, creating a cozy gathering space. The kitchen includes a walk-in pantry, offering plenty of storage for all your essentials. A small covered patio at the front of the home adds a charming touch. Upstairs, the master bedroom offers a spacious walk-in closet for your wardrobe needs. The laundry room, conveniently located on this floor, comes with counter space for folding.