

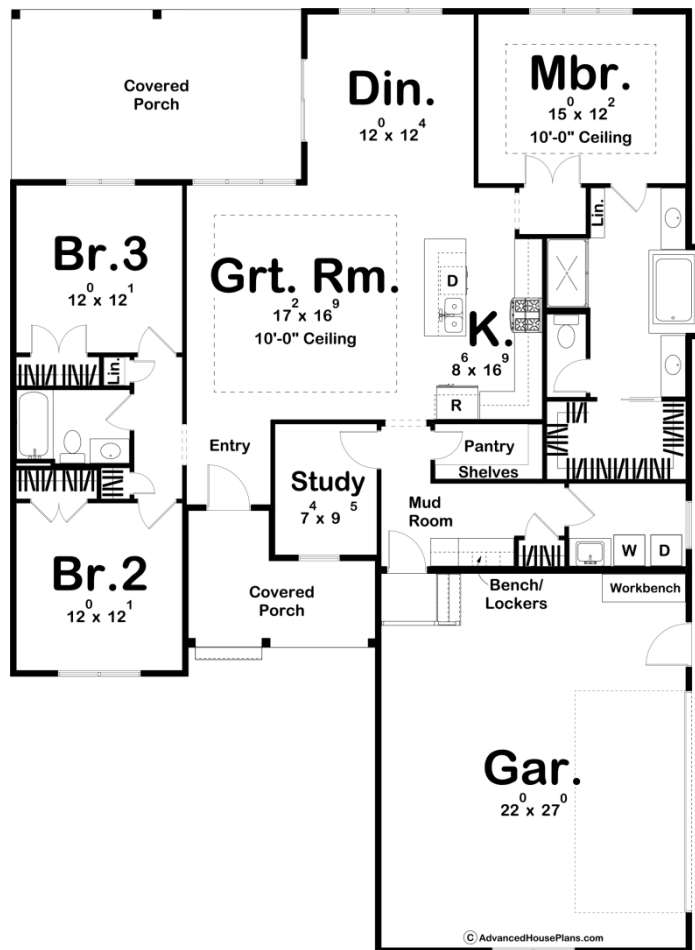

29900 - Trenton Data Sheet

1797 SQ FT	3 BEDS	2 BATHS	2 BAYS	50' 0" WIDE	68' 0" DEEP
---------------	-----------	------------	-----------	----------------	----------------



Construction Specs

Layout

Bedrooms

Bathrooms	2
-----------	---

Garage Bays	2
-------------	---

Square Footage

Main Level	1797 Sq. Ft.
------------	--------------

Covered Area	364 Sq. Ft.
--------------	-------------

Garage	616 Sq. Ft.
--------	-------------

Total Finished Area	1797 Sq. Ft.
---------------------	--------------

Exterior Dimensions

Width	50' 0"
-------	--------

Depth	68' 0"
-------	--------

Default Construction Stats

Stats are unique to the individual plan.

Foundation Type	Slab
-----------------	------

Exterior Wall Construction	2x4
----------------------------	-----

Roof Pitches	8/12 Primary
--------------	--------------

Main Wall Height	9'
------------------	----

Plan Description

An appealing front porch and board and batten siding give this Modern Farmhouse ranch plan unique charm. Inside this affordable house plan, guests are welcomed by a trayed decorative ceiling in the open great room/ kitchen concept. The L-shaped kitchen and island adjoin the dining area, which opens up to a rear covered porch, where guests can mingle before dinner is served. A generously sized master suite is tucked away for privacy behind the kitchen and includes a trayed ceiling. The well-appointed master bath includes a large whirlpool tub, shower, compartmented toilet, and walk-in closet. Two additional bedrooms occupy this 1 story house plan, Bedroom 3 offers a birds-eye view of the covered porch outside. This 1 story house plan also features a 2 car side load garage.