

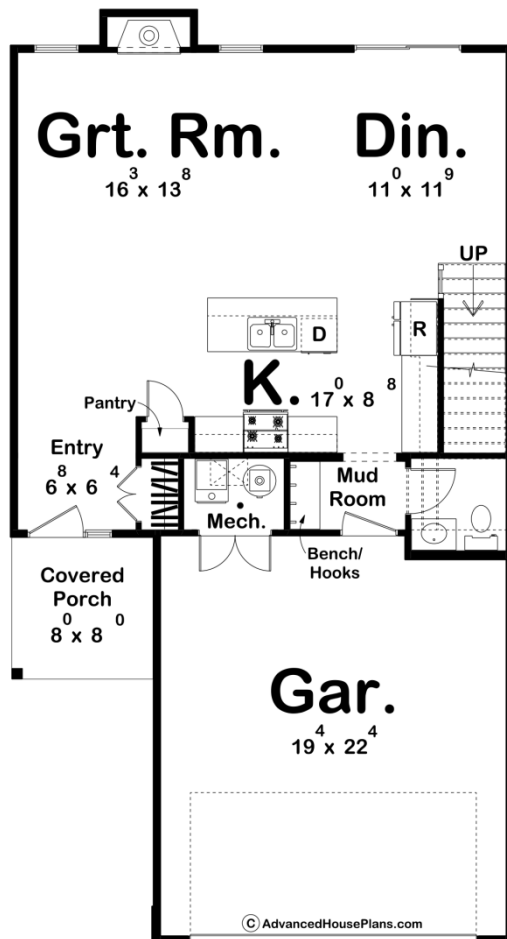

30315 - Urbana Data Sheet

1593 SQ FT	3 BEDS	3 BATHS	2 BAYS	28' 0" WIDE	52' 0" DEEP
---------------	-----------	------------	-----------	----------------	----------------

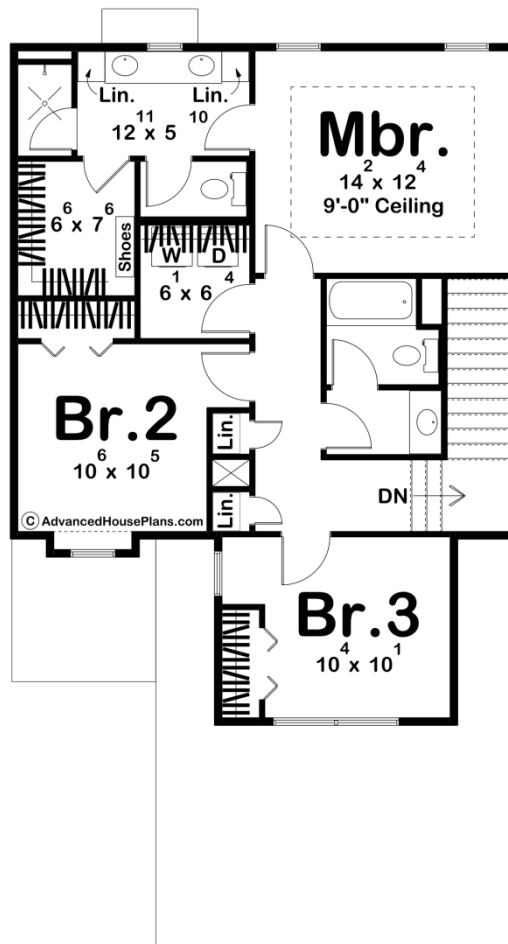



Construction Specs

Layout

Bedrooms	3
Bathrooms	3
Garage Bays	2

Square Footage

Main Level	751 Sq. Ft.
Second Level	842 Sq. Ft.
Garage	445 Sq. Ft.
Total Finished Area	1593 Sq. Ft.

Exterior Dimensions

Width	28' 0"
Depth	52' 0"
Ridge Height	23' 8"
<i>Calculated from main floor line</i>	

Default Construction Stats

Stats are unique to the individual plan.

Foundation Type	Slab
Exterior Wall Construction	2x4
Roof Pitches	Primary 4/12, Secondary 6/12
Main Wall Height	9'
Second Wall Height	8'

Plan Description

Welcome to this contemporary two-story home that seamlessly blends modern aesthetics with functional design. Situated on a well-manicured lot, this residence boasts a striking exterior featuring clean lines and a sleek façade. The front of the house is adorned with a spacious two-car front load garage, providing both convenience and a seamless integration with the overall design. A covered porch welcomes you to the entrance, offering a sheltered space to greet guests or enjoy the outdoors. Upon entering the home, you are greeted by an open-concept living space that combines the living, dining, and kitchen areas. The kitchen is equipped with state-of-the-art appliances, sleek cabinetry, and a central island, making it both a functional workspace and a stylish focal point. Ascending the staircase to the second floor, you'll find three bedrooms, each designed with comfort and style in mind. The master suite is a luxurious retreat, complete with an ensuite bathroom and ample closet space. The remaining bedrooms share a well-appointed bathroom, featuring modern fixtures and finishes. Throughout the home, high-quality materials, such as hardwood floors and contemporary tiles, contribute to the overall modern aesthetic.