

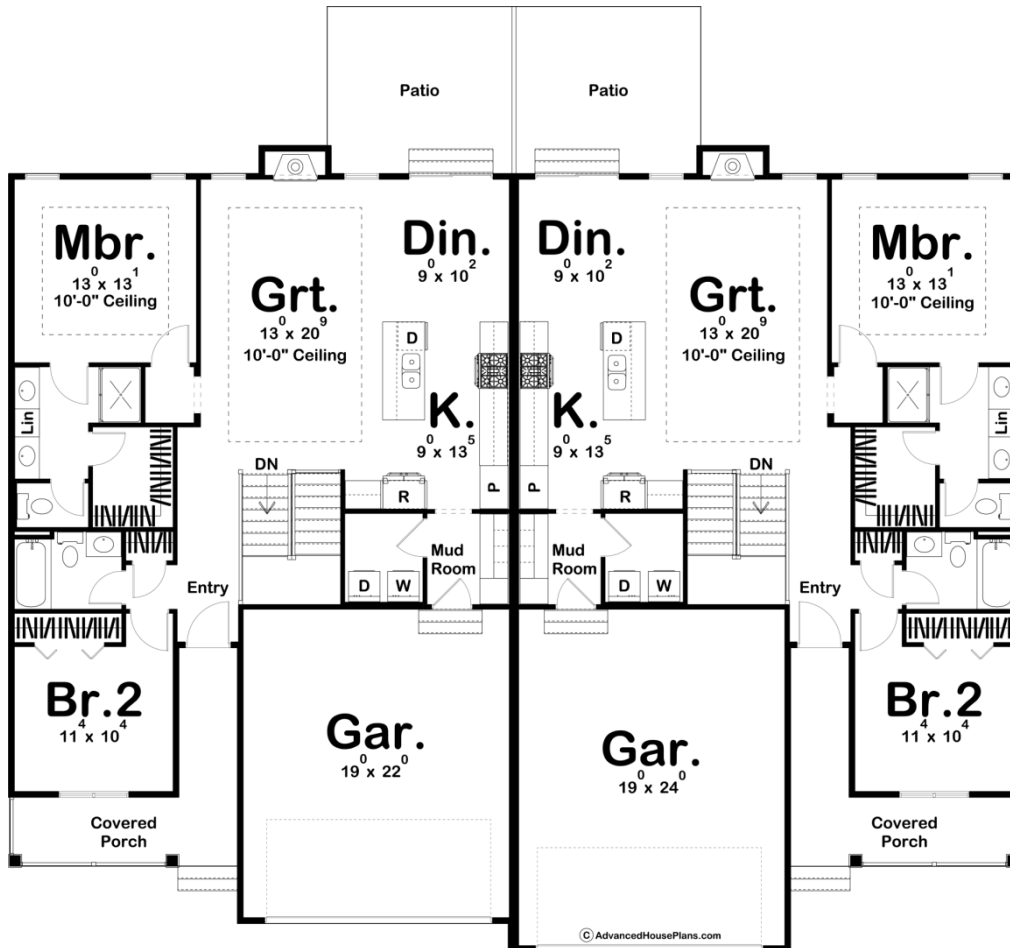

30203 - Urbandale Data Sheet

1258 SQ FT	2 BEDS	2 BATHS	2 BAYS	72' 0" WIDE	67' 4" DEEP
---------------	-----------	------------	-----------	----------------	----------------

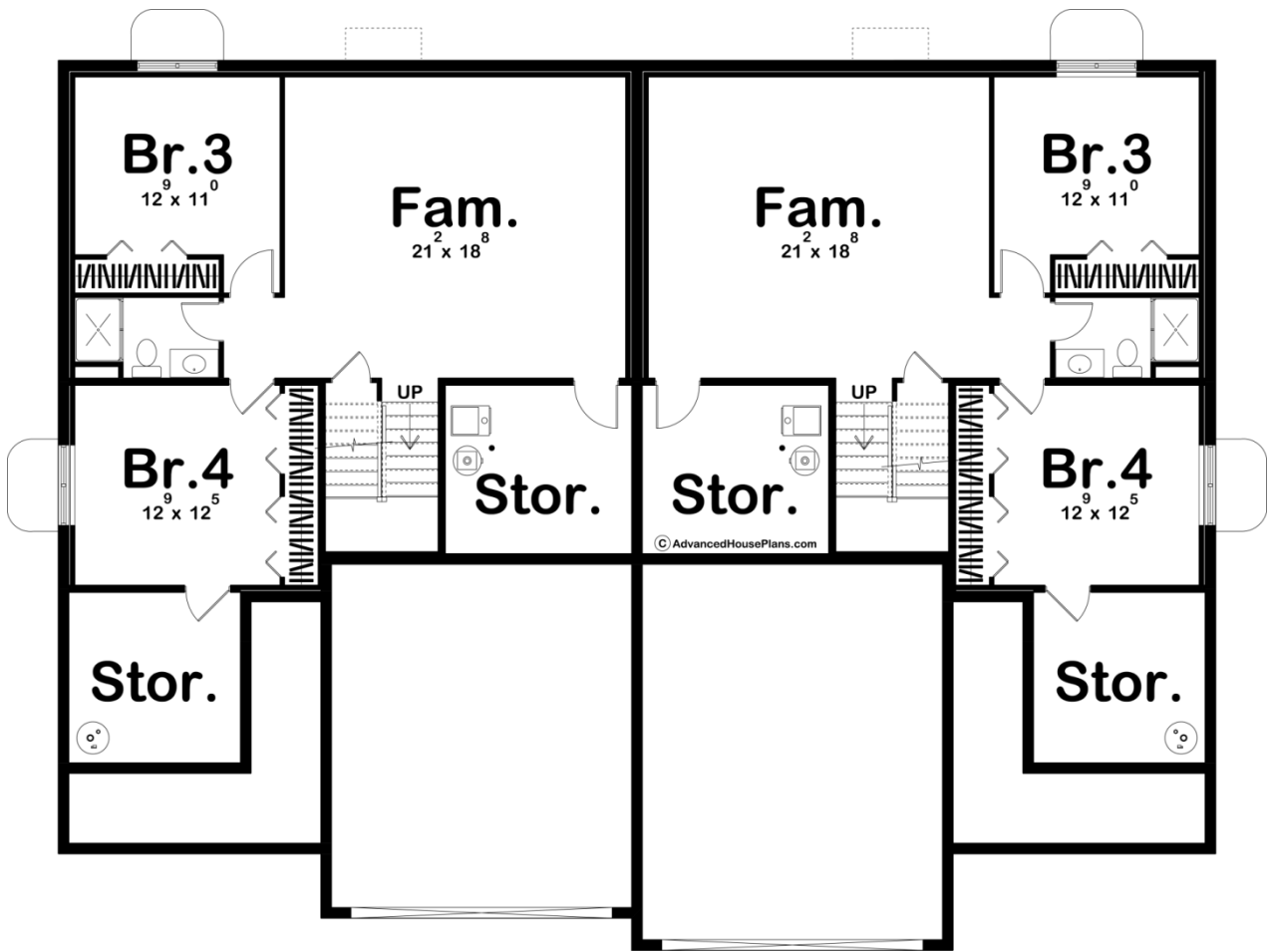



Construction Specs

Layout

Bedrooms	2
Bathrooms	2
Garage Bays	2

Square Footage

Main Level	1258 Sq. Ft.
Covered Area	128 Sq. Ft.
Garage	498 Sq. Ft.
Total Finished Area	1258 Sq. Ft.

Exterior Dimensions

Width	72' 0"
Depth	67' 4"
Ridge Height	22' 11"

Calculated from main floor line

Default Construction Stats

Stats are unique to the individual plan.

Foundation Type	Basement
Exterior Wall Construction	2x4
Roof Pitches	Primary 6/12, Secondary 8/12, 4/12, 3/12
Foundation Wall Height	9'
Main Wall Height	9'

Plan Description

The Urbandale plan is a modern farmhouse style duplex that is perfect for those who want an updated space while keeping it practical. This plan's exterior provides an elegance and rustic curb appeal, sure to attract anyone that drives by. Being almost symmetrical, Urbandale has minor details making it different from each side. Step into either door to find the same plan, separated by a partition. The large, two-car garage walks straight into a mudroom, complete with an area for laundry. Continue through here to be greeted by a spacious kitchen and dining room. While saving space by separating this home into two, it still feels incredibly large due to the open floor plan. The kitchen, dining, and great room are all one, making this area perfect for relaxing with the family after a large meal. The home is complete with a patio and two bedrooms, one being the master suite with a large walk-in closet and a double vanity. While there is one additional bedroom on the main floor, having an optional finished basement can give you two more and another bathroom. An additional family room as well as two large storage spaces are also included in the basement, and would make this home perfect for any family.