

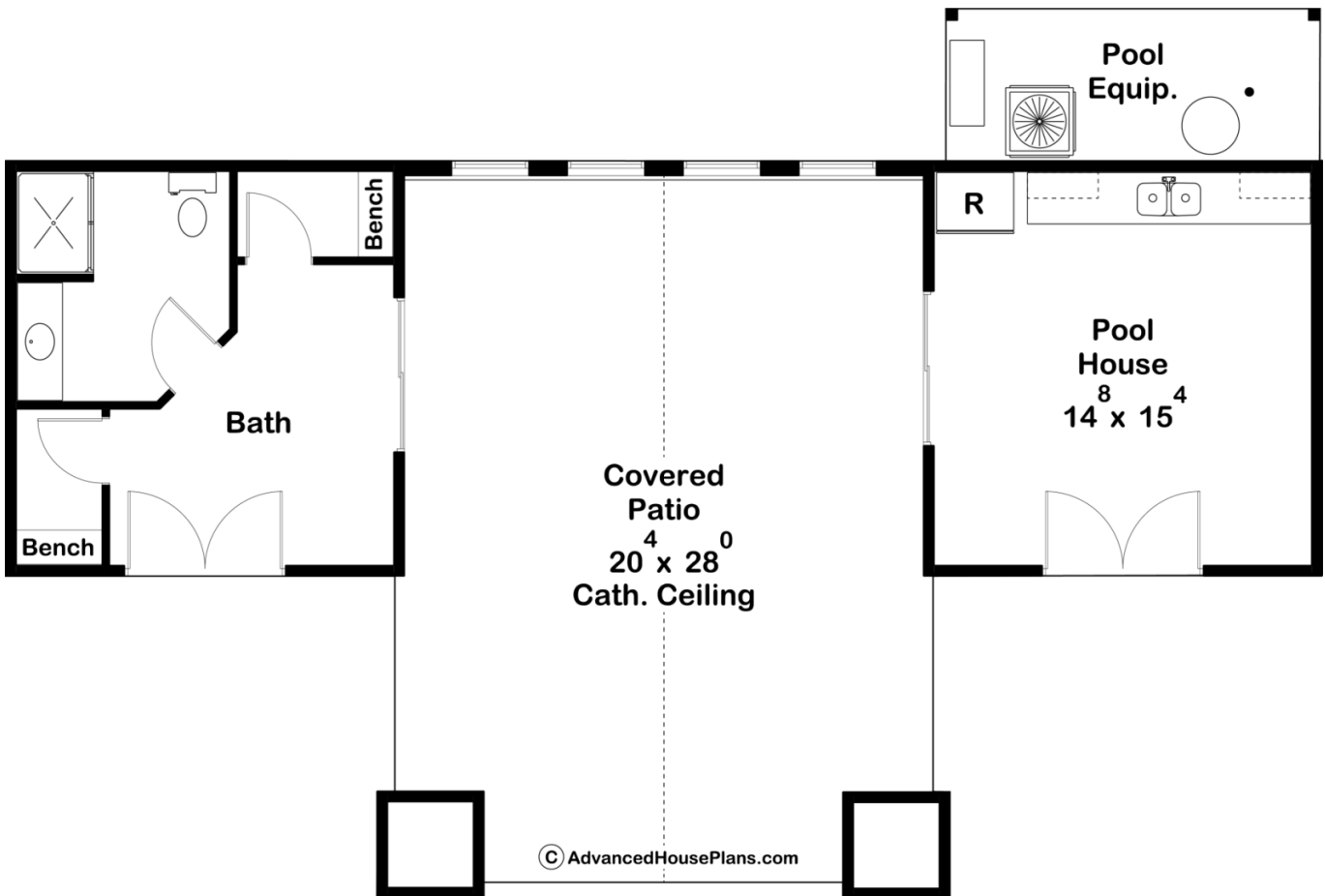

29562 - Waldron Data Sheet

| | | | | | |
|--------------|-----------|------------|-----------|----------------|----------------|
| 490 SQ FT | 0 BEDS | 0 BATHS | 0 BAYS | 51' 0" WIDE | 34' 0" DEEP |
|--------------|-----------|------------|-----------|----------------|----------------|



Construction Specs

| |
|----------------|
| Layout |
| Square Footage |

| | |
|---------------------|-------------|
| Main Level | 490 Sq. Ft. |
| Covered Area | 571 Sq. Ft. |
| Total Finished Area | 490 Sq. Ft. |

Exterior Dimensions

| | |
|--|--------|
| Width | 51' 0" |
| Depth | 34' 0" |
| Ridge Height <i>Calculated from main floor line</i> | 18' 0" |

Default Construction Stats

Stats are unique to the individual plan.

| | |
|----------------------------|--------------|
| Foundation Type | Slab |
| Exterior Wall Construction | 2x4 |
| Roof Pitches | 8/12 Primary |
| Main Wall Height | 10' |

Plan Description

The Waldron pool house is a craftsman style pool house with plenty of outdoor space. The covered patio is great for entertaining at any time of the day, with detailed wood trusses and stone covered columns. On the inside lies a counter that is equipped with a sink for all your prepping needs and spaces for a refrigerator and table. On the other side of the patio lies a 3/4 bath with a roomy shower. This pool house plan provides everything you need including a storage space for all pool equipment, including floaties!