

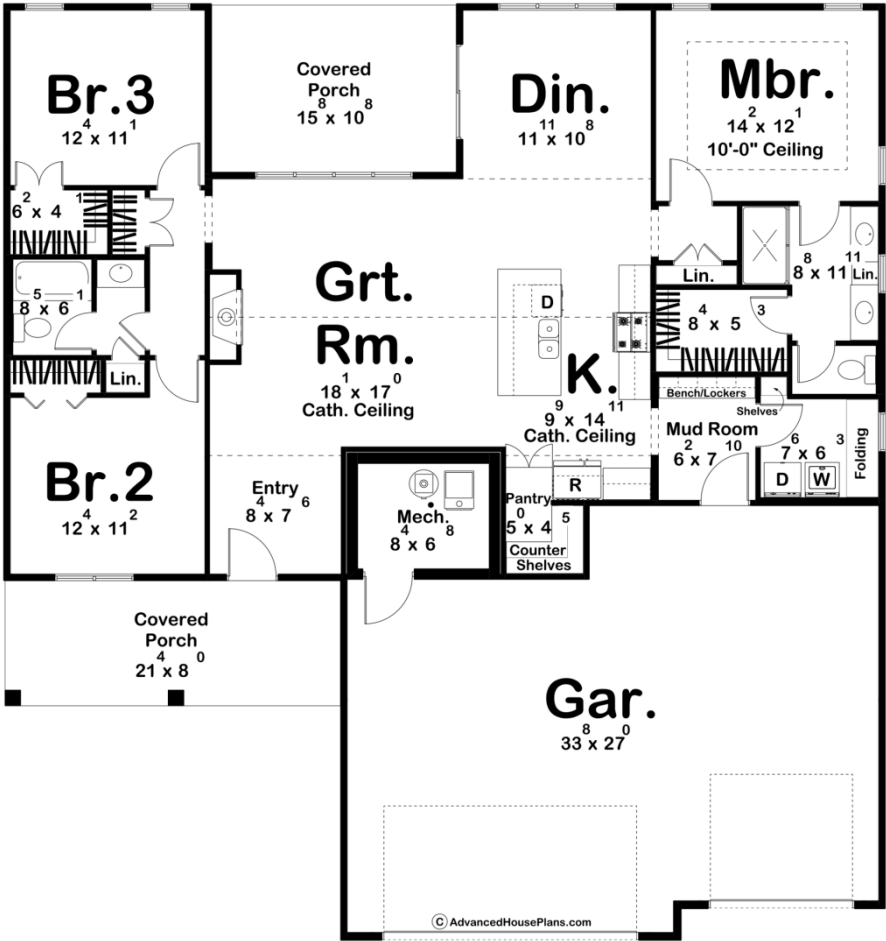

30534 - Walworth Data Sheet

1689 SQ FT	3 BEDS	2 BATHS	3 BAYS	55' 8" WIDE	59' 0" DEEP
---------------	-----------	------------	-----------	----------------	----------------



Construction Specs

Layout

Bedrooms

Bathrooms	2
Garage Bays	3
<b>Square Footage</b>	
Main Level	1689 Sq. Ft.
Covered Area	337 Sq. Ft.
Garage	839 Sq. Ft.
Total Finished Area	1689 Sq. Ft.
<b>Exterior Dimensions</b>	
Width	55' 8"
Depth	59' 0"
Ridge Height <i>Calculated from main floor line</i>	20' 7"
<b>Default Construction Stats</b> <i>Stats are unique to the individual plan.</i>	
Foundation Type	Slab
Exterior Wall Construction	2x4
Roof Pitches	Primary 6/12
Main Wall Height	9'

## Plan Description

Welcome to a charming 1-story traditional style home, designed for comfort and practicality. This residence features a spacious layout with 3 bedrooms, 2 bathrooms, and a 3-car garage, ensuring ample space for both living and storage needs. As you approach the house, a gracious front covered porch invites you to step inside. Upon entering, you're greeted by an expansive open floor plan that seamlessly connects the great room and kitchen area. The cathedral ceiling enhances the sense of openness and airiness in this central living space, creating a feeling of grandeur and warmth.The kitchen, a focal point of the home, boasts modern amenities and ample counter space, perfect for both everyday meals and entertaining guests. Adjacent to the kitchen is a dining area, strategically positioned to overlook the rear covered porch, ideal for enjoying meals outdoors or simply relaxing with a cup of coffee.The bedrooms are well-appointed, offering comfort and privacy. The master bedroom includes an ensuite bathroom and generous closet space, while the additional bedrooms share a conveniently located full bathroom.With its thoughtful layout and blend of functionality and elegance, this 1-story house plan embodies the essence of comfortable living, making it a perfect retreat for families or individuals looking to enjoy a relaxed lifestyle.