

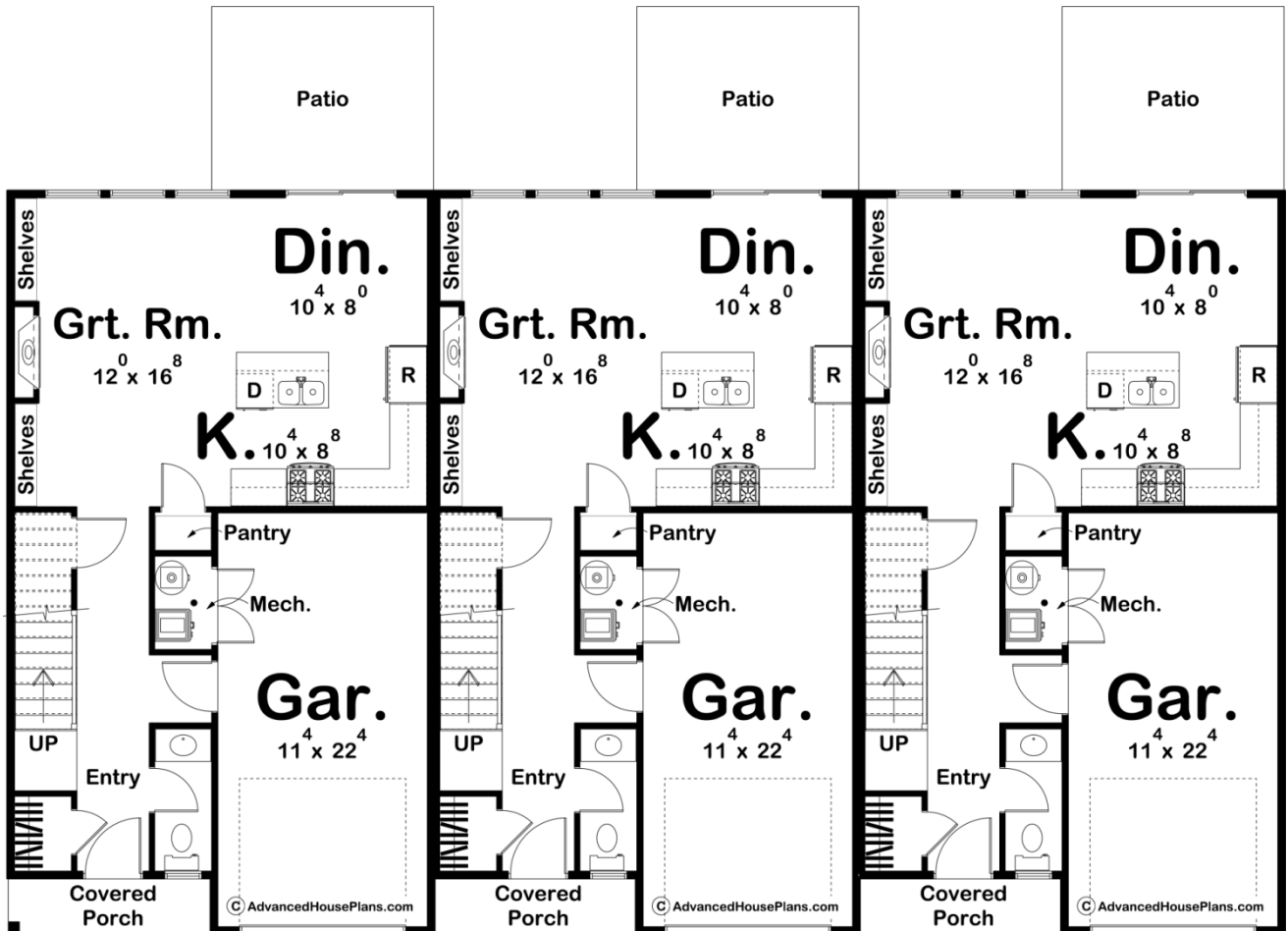

**30151 - Watertown Data Sheet**

1464 SQ FT	3 BEDS	3 BATHS	1 BAYS	69' 0" WIDE	40' 0" DEEP
---------------	-----------	------------	-----------	----------------	----------------

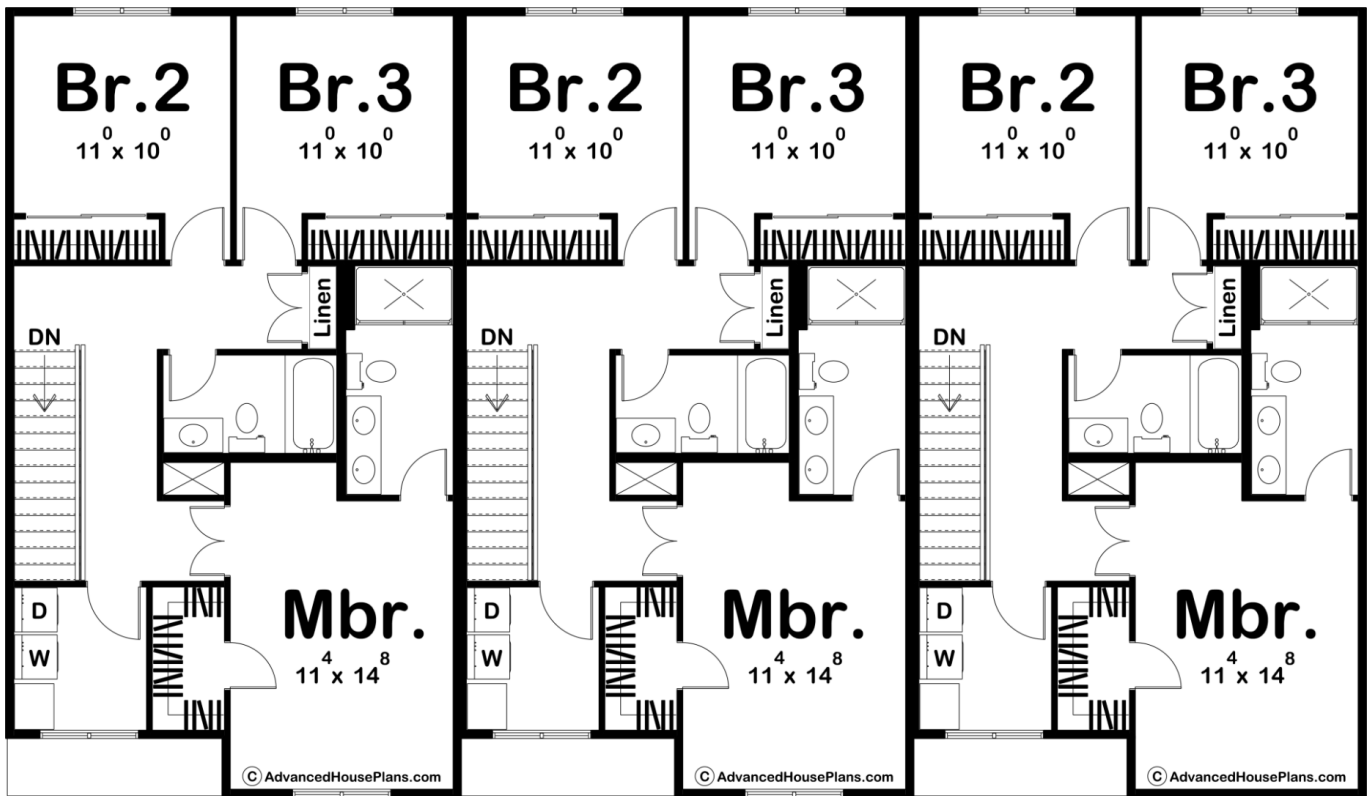



## Construction Specs

### Layout

Bedrooms	3
Bathrooms	3
Garage Bays	1

### Square Footage

Main Level	622 Sq. Ft.
Second Level	842 Sq. Ft.
Covered Area	33 Sq. Ft.
Garage	264 Sq. Ft.
Total Finished Area	1464 Sq. Ft.

### Exterior Dimensions

Width	69' 0"
Depth	40' 0"
Ridge Height	30' 0"
<i>Calculated from main floor line</i>	

### Default Construction Stats

*Stats are unique to the individual plan.*

Foundation Type	Slab
Exterior Wall Construction	2x4
Roof Pitches	6/12 Primary, 10/12 Secondary
Main Wall Height	9'
Second Wall Height	8'

## Plan Description

The Watertown is the triplex version of our Tara Hills plan. It is an affordable 2-Story Modern Farmhouse style plan. The exterior features board and batten siding and a covered porch. The great room, kitchen, and dining room flow seamlessly in an open layout. The great room is warmed by a fireplace that is flanked by built-in bookshelves. The L-shaped kitchen includes an island and a reach-in pantry. A sliding glass door leads to the rear patio from the dining room. Upstairs, you'll find 3 bedrooms. The master suite includes a bathroom with dual vanities and a walk-in shower. Bedrooms 2 and 3 share a centrally located hall bathroom.