

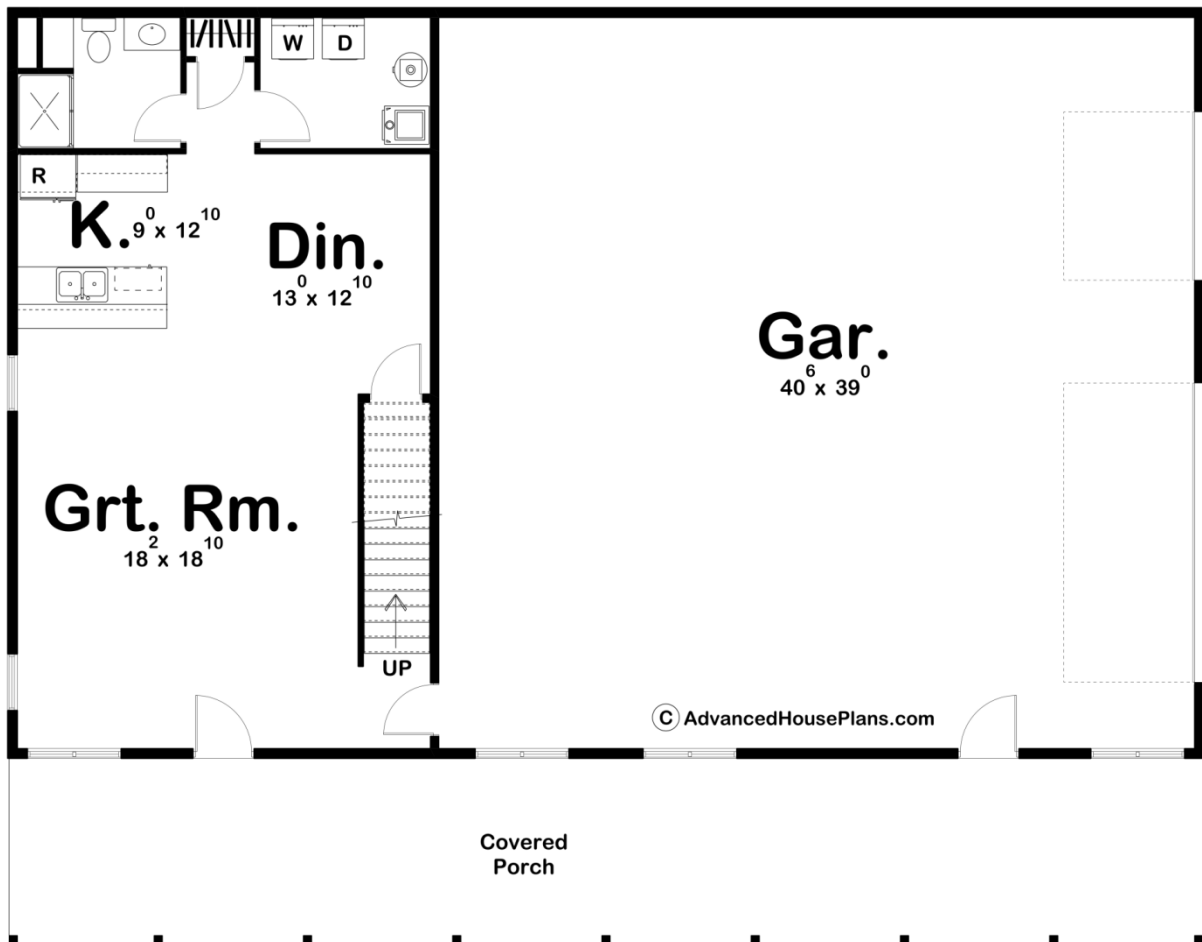

29674 - Westminster Data Sheet

1326 SQ FT	1 BEDS	1 BATHS	3 BAYS	64' 0" WIDE	50' 0" DEEP
---------------	-----------	------------	-----------	----------------	----------------

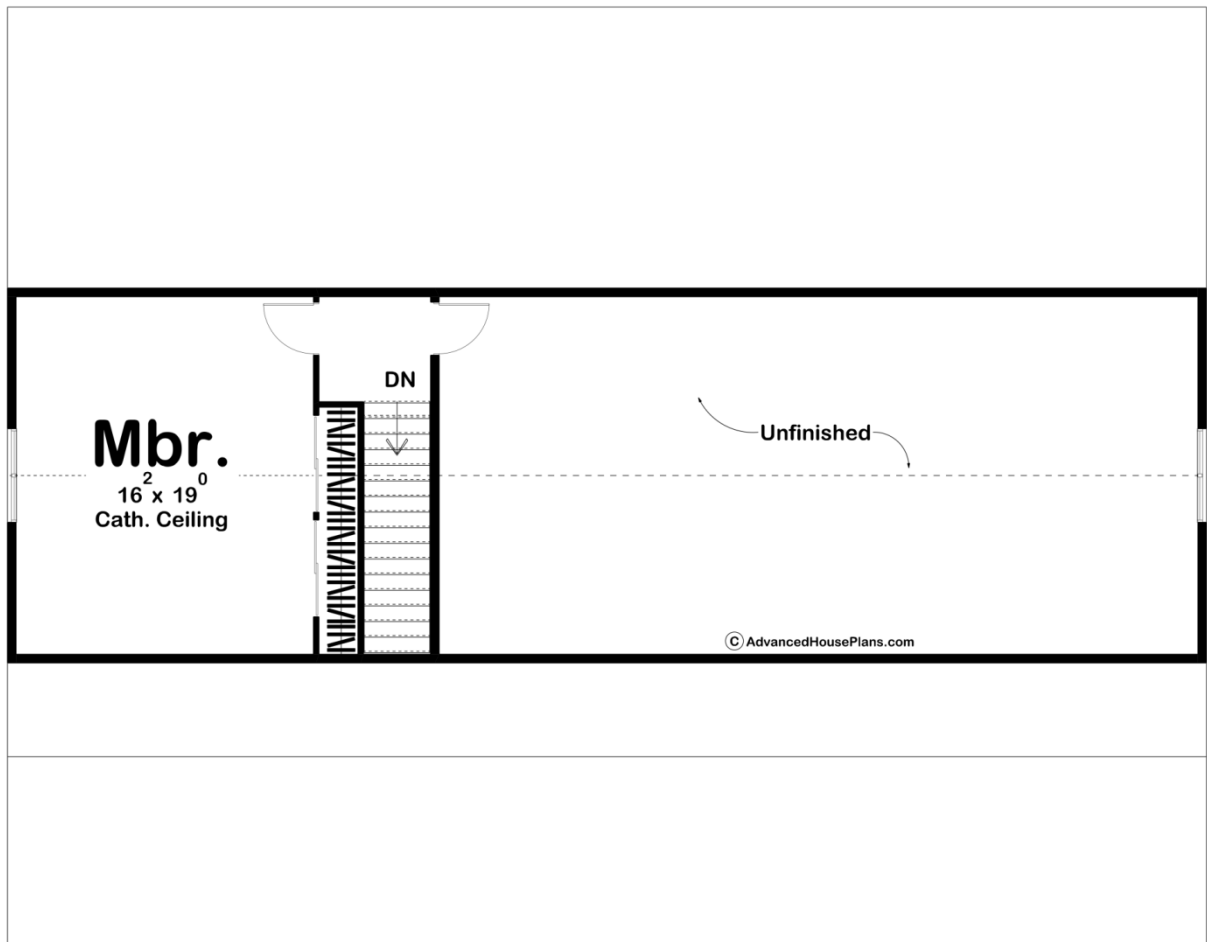



Construction Specs

Layout

Bedrooms	1
Bathrooms	1
Garage Bays	3

Square Footage

Main Level	922 Sq. Ft.
Second Level	404 Sq. Ft.
Garage	1638 Sq. Ft.
Total Finished Area	1326 Sq. Ft.

Exterior Dimensions

Width	64' 0"
Depth	50' 0"

Default Construction Stats

Stats are unique to the individual plan.

Foundation Type	Slab
-----------------	------

Exterior Wall Construction	Post Frame
Roof Pitches	6/12 Primary
Main Wall Height	10'

Plan Description

The Westminster post frame home features a 1638 square foot garage, a 922 square foot main level and a 404 square foot loft. A covered porch along the entire side of the home makes for a great space to sit and enjoy a drink, the sunset, or quality time with loved ones. Upon entering through the garage or porch, you immediately step into the great room, where you can head upstairs to the master bedroom or unfinished loft. The great room leads into the kitchen and dining area, where you have a gorgeous breakfast bar. The space is just open enough to not make it too cluttered and still enjoyable for entertaining. There is one bathroom behind the kitchen, as well as a walk-in laundry room. While the space is smaller than most homes, building a post frame is a much more economical way of building a home over traditional stick-built homes.