

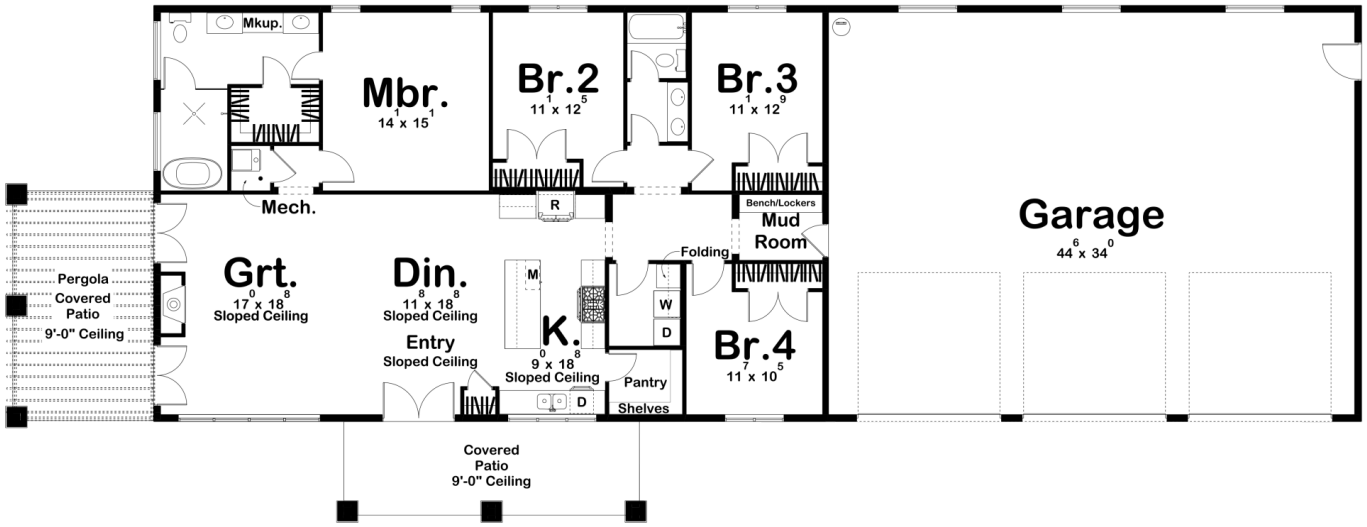

30282 - Whalen Flats Data Sheet

1982 SQ FT	4 BEDS	2 BATHS	3 BAYS	114' 4" WIDE	43' 4" DEEP
---------------	-----------	------------	-----------	-----------------	----------------



Construction Specs

Layout

Bedrooms

Bathrooms	2
Garage Bays	3
Square Footage	
Main Level	1982 Sq. Ft.
Covered Area	195 Sq. Ft.
Garage	1576 Sq. Ft.
Total Finished Area	1982 Sq. Ft.
Exterior Dimensions	
Width	114' 4"
Depth	43' 4"
Ridge Height <i>Calculated from main floor line</i>	18' 7"
Default Construction Stats <i>Stats are unique to the individual plan.</i>	
Foundation Type	Slab
Exterior Wall Construction	2x6
Roof Pitches	2/12 Primary
Main Wall Height	12'

Plan Description

This modern barndominium has a touch that makes the home not only feel luxurious, but also comfortable. As soon as you step in through the oversized 3-car garage, you are greeted by a beautiful mudroom. Stepping in further you will find the kitchen, dining, and great room. The kitchen features a walk-in pantry and a large island looking into the open great room. The great room has a tall fireplace with French doors on either side. This plan has 4 bedrooms with plenty of room for guests. The master bedroom includes a large double vanity bathroom with a separate shower room. Step outside onto the covered patio and under the gorgeous pergola, perfect for adding lights to create the perfect mood for your evenings. This barndominium is unlike any other, and a perfect space for all things entertaining.