

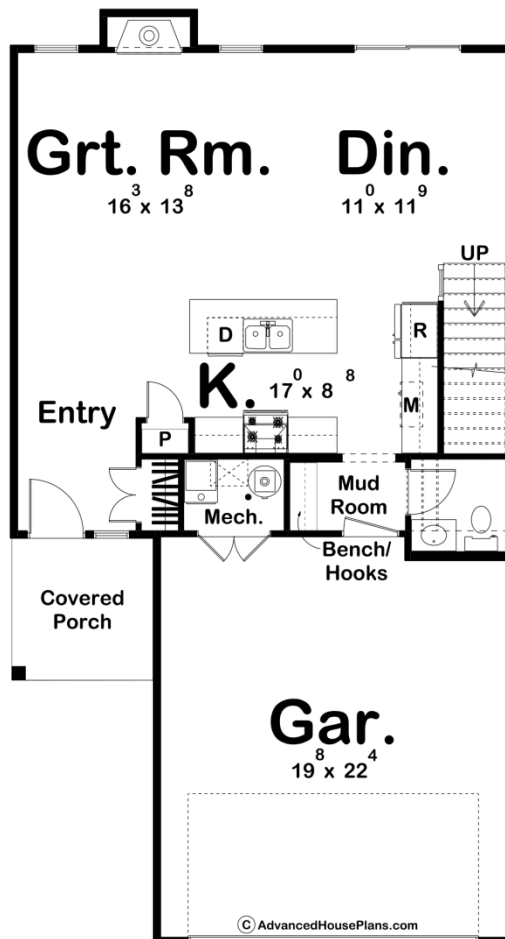

30243 - Whitehurst Data Sheet

| | | | | | |
|---------------|-----------|------------|-----------|----------------|----------------|
| 1587 SQ FT | 3 BEDS | 3 BATHS | 2 BAYS | 28' 0" WIDE | 52' 0" DEEP |
|---------------|-----------|------------|-----------|----------------|----------------|

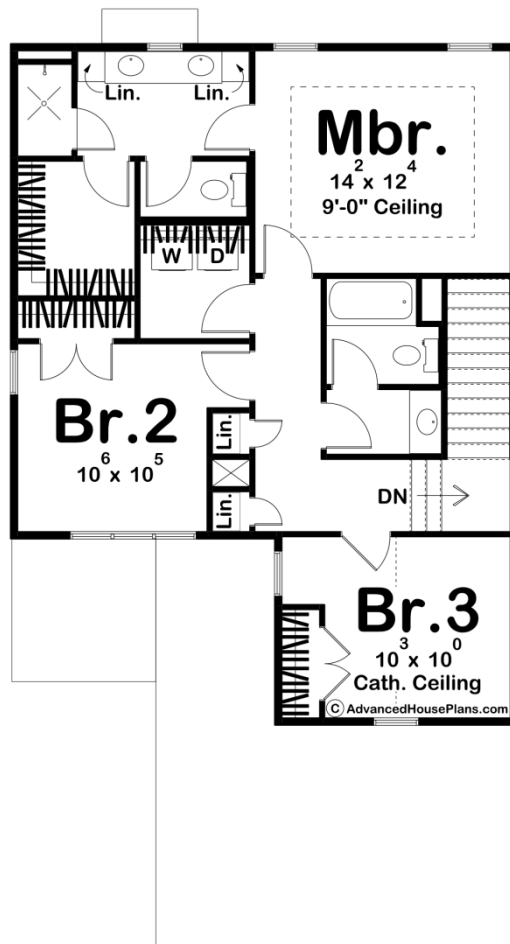



Construction Specs

Layout

| | |
|-------------|---|
| Bedrooms | 3 |
| Bathrooms | 3 |
| Garage Bays | 2 |

Square Footage

| | |
|---------------------|--------------|
| Main Level | 749 Sq. Ft. |
| Second Level | 838 Sq. Ft. |
| Covered Area | 64 Sq. Ft. |
| Garage | 445 Sq. Ft. |
| Total Finished Area | 1587 Sq. Ft. |

Exterior Dimensions

| | |
|--|--------|
| Width | 28' 0" |
| Depth | 52' 0" |
| Ridge Height | 26' 6" |
| <i>Calculated from main floor line</i> | |

Default Construction Stats

Stats are unique to the individual plan.

| | |
|----------------------------|-------------------------------|
| Foundation Type | Slab |
| Exterior Wall Construction | 2x4 |
| Roof Pitches | Primary 12/12, Secondary 4/12 |
| Main Wall Height | 9' |
| Second Wall Height | 8' |

Plan Description

The Whitehurst plan is a gorgeous modern farmhouse style plan that is complete with 1587 square feet, 3 bedrooms, and 3 bathrooms. The board and batten siding of this home with the wood accents makes it a unique yet trendy modern farmhouse with all the proper touches. The covered porch heading into the entryway is a beautiful stoop to head into an even more beautiful interior. The great room, dining, and kitchen are all found here with an open concept, built-in fireplace, island, and plenty of counter space. The mudroom and powder bath near the entrance of the two-car garage can also be found here. Head upstairs to find the bedrooms, the master complete with a double vanity, separate shower and toilet areas and a large walk-in closet, the laundry room, and bedrooms two and three which share a Hollywood bathroom. Love this plan, check out our Ridgehaven plan, #30238.