

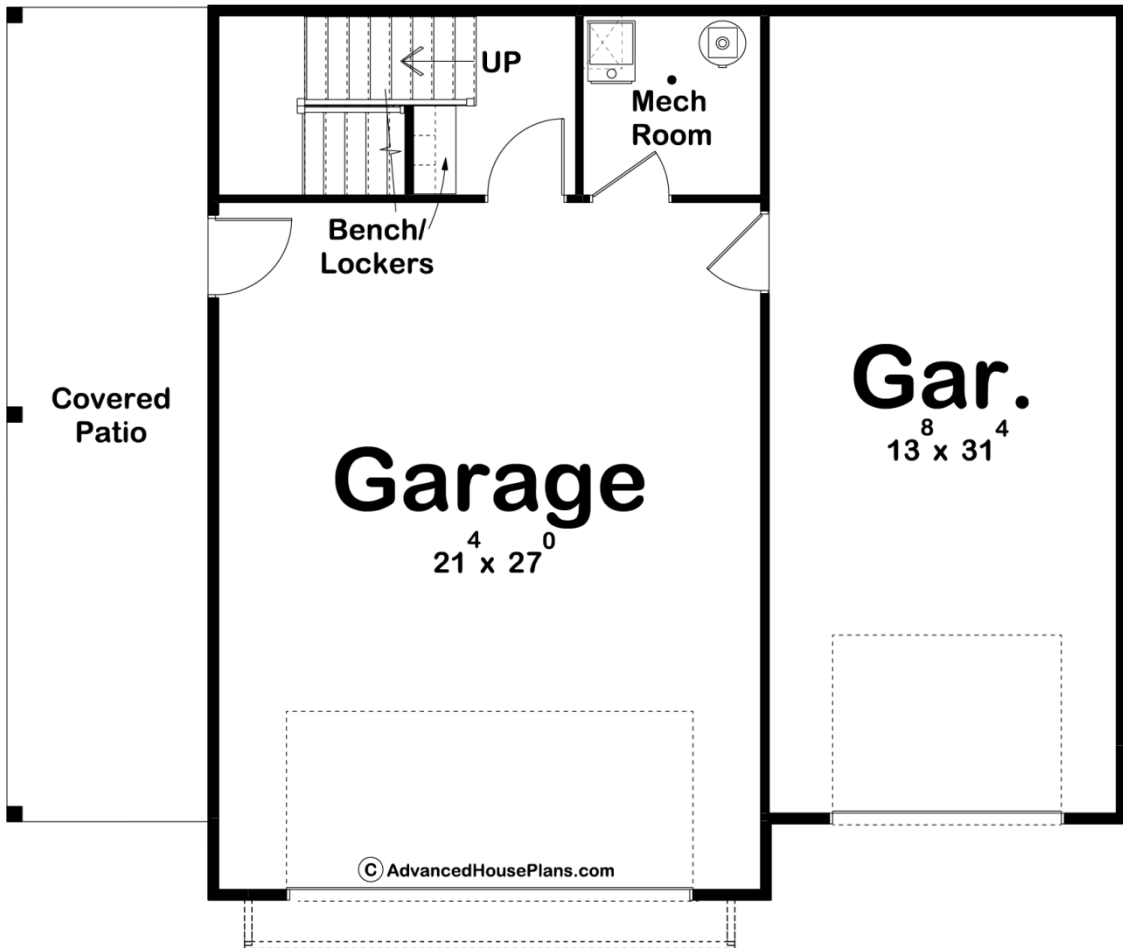

### 29967 - Willow Point Data Sheet

807 SQ FT	1 BEDS	1 BATHS	3 BAYS	44' 0" WIDE	35' 0" DEEP
--------------	-----------	------------	-----------	----------------	----------------

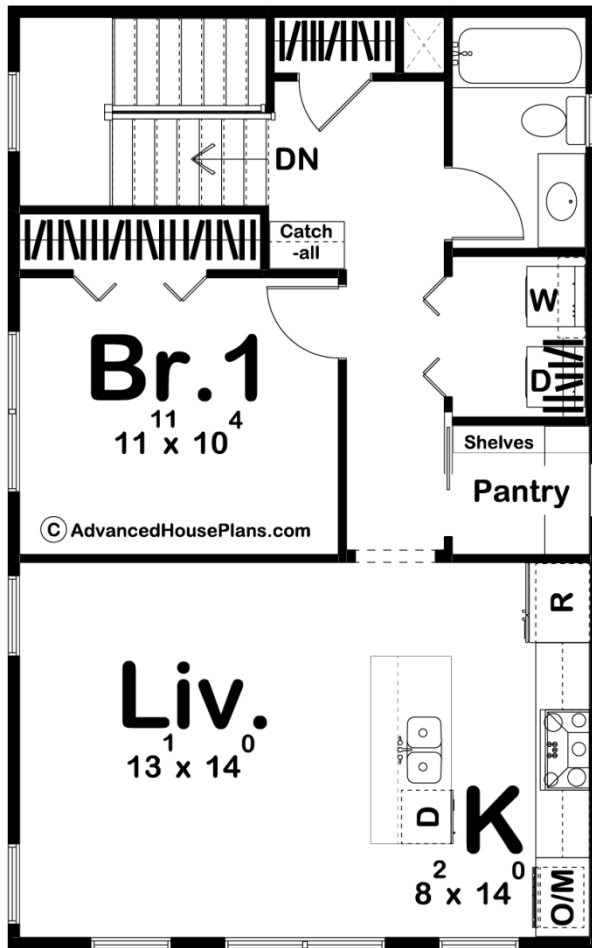



## Construction Specs

Layout	
Bedrooms	1
Bathrooms	1
Garage Bays	3
Square Footage	
Main Level	106 Sq. Ft.
Second Level	701 Sq. Ft.
Covered Area	256 Sq. Ft.
Garage	1056 Sq. Ft.
Total Finished Area	807 Sq. Ft.
Exterior Dimensions	
Width	44' 0"
Depth	35' 0"
Ridge Height	28' 0"
<i>Calculated from main floor line</i>	

### Default Construction Stats

*Stats are unique to the individual plan.*

Foundation Type	Slab
Exterior Wall Construction	2x4
Roof Pitches	8/12 Primary, 3/12 Secondary
Main Wall Height	9'
Second Wall Height	9'

## Plan Description

Modern farmhouse styling gives the Willow Point excellent curb appeal. The exterior highlights beautiful wood accents and garage doors with board and batten siding. This carriage house plan features a 3 car garage on the main level with an apartment above. The apartment includes 1 bedroom and 1 bathroom. The living room and kitchen are arranged in an open layout. The kitchen features an island and a walk-in pantry.