

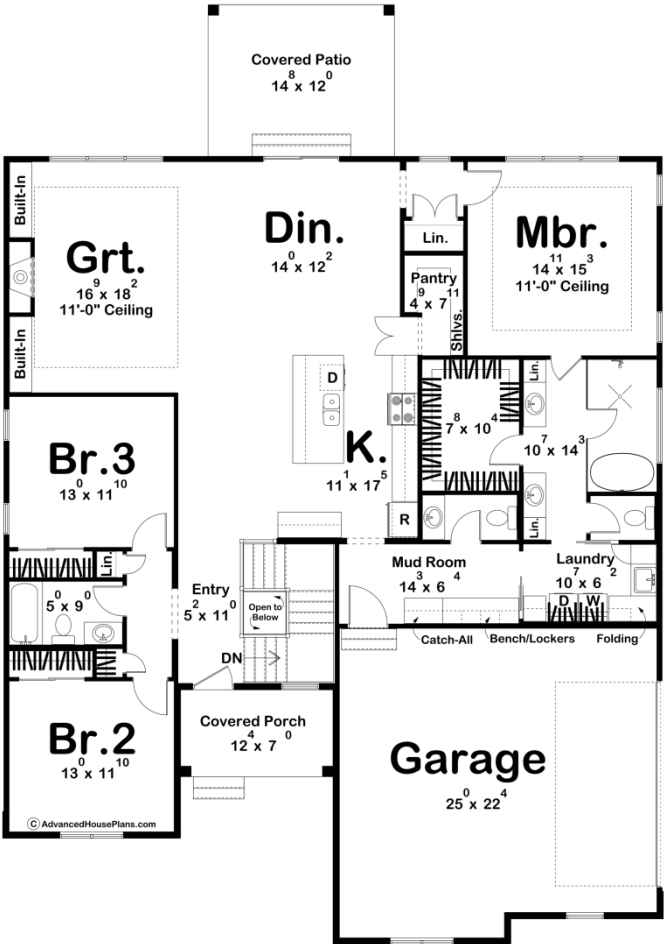

30579 - Winchester Data Sheet

|               |           |            |           |                |                |
|---------------|-----------|------------|-----------|----------------|----------------|
| 2196<br>SQ FT | 3<br>BEDS | 3<br>BATHS | 2<br>BAYS | 51' 8"<br>WIDE | 73' 8"<br>DEEP |
|---------------|-----------|------------|-----------|----------------|----------------|



Construction Specs

|        |
|--------|
| Layout |
|--------|

Bedrooms

|  |                                     |
|--|-------------------------------------|
| Bathrooms  | 3                                   |
| Garage Bays  | 2                                   |
| <b>Square Footage</b>  |                                     |
| Main Level   | 2196 Sq. Ft.                        |
| Covered Area   | 262 Sq. Ft.                         |
| Garage   | 606 Sq. Ft.                         |
| Total Finished Area  | 2196 Sq. Ft.                        |
| <b>Exterior Dimensions</b>   |                                     |
| Width  | 51' 8"                              |
| Depth  | 73' 8"                              |
| Ridge Height<br><i>Calculated from main floor line</i>                               | 22' 8"                              |
| <b>Default Construction Stats</b><br><i>Stats are unique to the individual plan.</i> |                                     |
| Foundation Type  | Basement                            |
| Exterior Wall Construction   | 2x4                                 |
| Roof Pitches   | Primary 6/12, Secondary 10/12, 3/12 |
| Foundation Wall Height   | 9'                                  |
| Main Wall Height   | 10'                                 |

## Plan Description

This 1-story modern farmhouse combines timeless appeal with modern elegance. The exterior features classic board and batten siding, enhanced by sophisticated thinset stone and warm wood accents. The side-load, 2-car garage adds convenience and boosts the home's curb appeal. A welcoming front covered porch greets visitors, while the rear covered patio offers a perfect spot for relaxation. Inside, the layout is designed for both comfort and privacy. The master bedroom, located on one side of the house, provides a peaceful retreat with its own en-suite bathroom. On the opposite side, two additional bedrooms and one bathroom cater to family or guests. At the heart of the home is an open-concept living area, ideal for entertaining and everyday living. The kitchen, complete with a walk-in pantry, is a chef's delight with ample storage space. This modern farmhouse blends style and functionality, creating a beautiful and practical home for contemporary living.